

GARNET XS4

CNC Profile Machining Center (4 Axis)

Automation by
FANUC



Thanks to its spindle which can operate in -90, 0 and +90 fixed angles, the 4 axis CNC machining center, **GARNET XS4** can process different sizes of aluminum and PVC profiles and offer a wide spectrum of solutions to the user. The machine is developed to carry out all-in-one milling, drain channel opening, punching, marking and end milling operations on aluminum and PVC profiles, and to perform special non-standard operations on different profiles. The high processing capacity (340 mm x 260 mm) provides satisfactory user experience with the machines' performance in all operations.



By focusing on providing convenient solutions for customers, and combining power and precision, GARNET XS4 lets the processing capacity be only limited by the users imagination, thanks to the 5 kW spindle motor with automatic tool replacement feature.



Thanks to its built-in automatic magazine with capacity for 8 tools, GARNET XS4 saves time when switching to different operations.



With full automatic clamp positioning, GARNET XS4 automates many tasks assuming the work load of the user.



Maintenance of transmission elements is accomplished by the automatic lubrication system which is offered as an optional feature increasing the service life for accuracy in processes. Capacity may be varied for processing of non-standard profiles with on demand optimization of size and number of clamps.

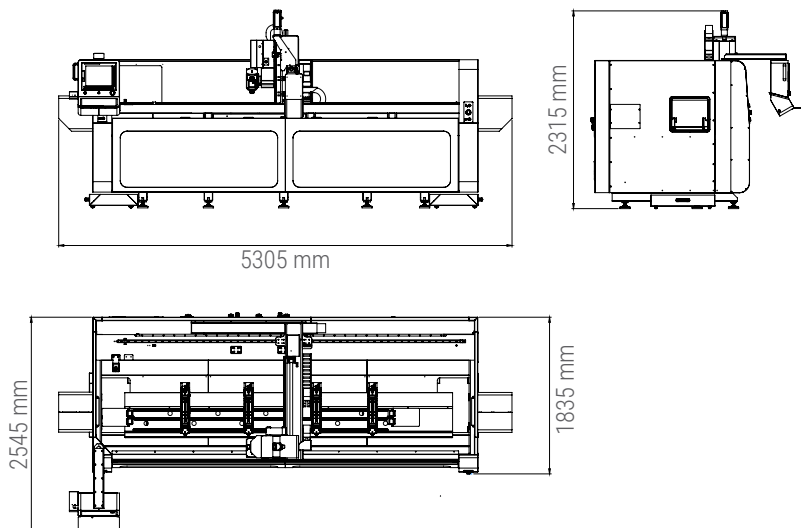

GARNET XS4

CNC Profile Machining Center (4 Axis)



MACHINING LENGTHS

X Axis (Longitudinal)	3000 mm
Y Axis (Lateral)	340 mm
Z Axis (Vertical)	260 mm
A Axis (Head processing angles)	-90° / +90°

POSITIONING SPEED

X Axis (Longitudinal)	90 m/min
Y Axis (Lateral)	60 m/min
Z Axis (Vertical)	20 m/min
A Axis (Rotational Movement)	166° /sec

AIR

Pressure	6-8 Bar
----------	---------

ELECTRICAL

Max. Power	8 kW
Voltage	400V 3P, N, PE AC
Frequency	50-60 Hz

SPINDLE

Max. Power	5 kW
Maximum rotation speed	S1-5.6 kW / S6-7 kW HITECO
Tool holder	HSK F50
Cooling type	Liquid

TOOL STORAGE

Automatic Linear Type Tools Magazine	•
Maximum tool storage system number	8
Maximum saw blade diameter in to the storage system	150 mm
Tools Measuring	•

SCREW-CUTTING CAPACITY

Compressed tapping head	○
-------------------------	---

PROFILE POSITIONING

Right and left pneumatic profile reference alignment	•
--	---

CONTROL UNIT

Touch Screen	15"
Industrial PC - Touch Screen	•
Barcode reader	•
Smart CAM post processing	•
Camquix CAM software	•
CadXtract CAM software	○

OPERATIONAL AREA

Clamps, standard pcs	4
Clamps, maximum pcs	6
Automatic clamp positioning on X-axis	•
Automatic lubrication in processing area	•
Cabinet providing protection in processing zone	•
B&R automation system	○
Automatic lubrication system	○
FESTO pneumatic system	○
Side tunnels	•

• Standard ○ Optional