

# Knocka

## Assembly instructions

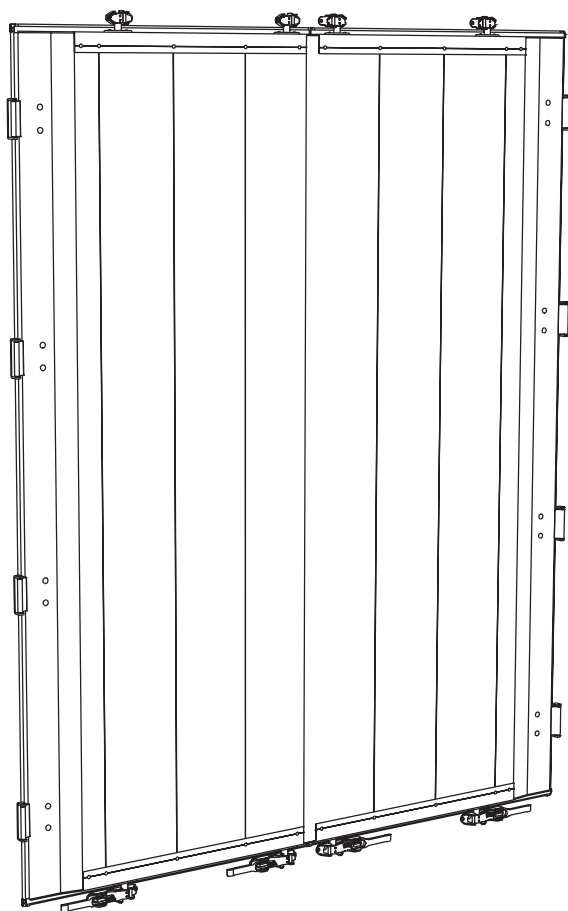



## Needed tools (not included):

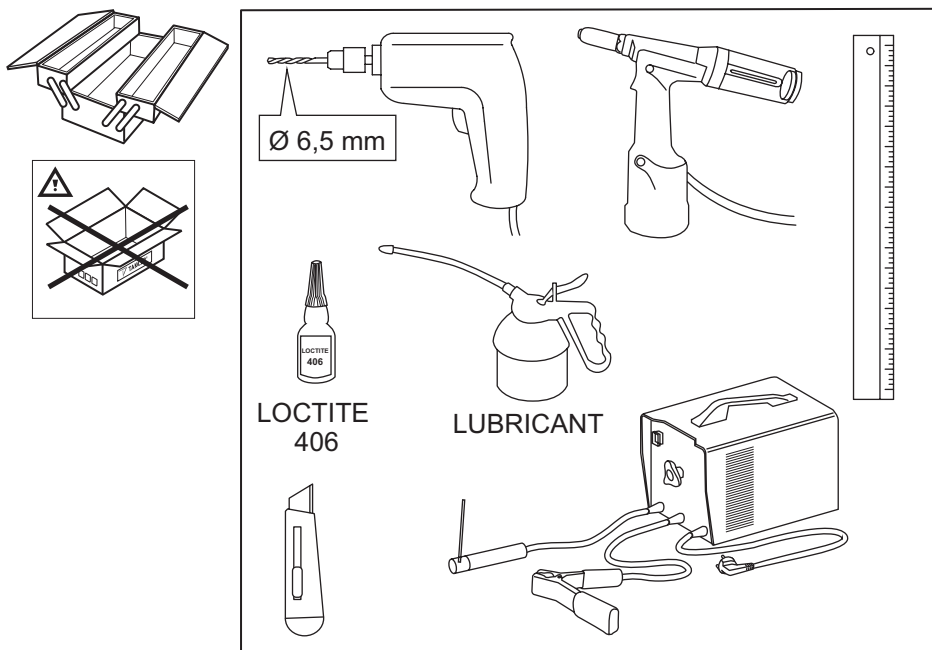

## Assembly warnings:

1. Make sure that the packing is complete with all pieces shown in the following page.
2. Make sure all pieces are intact. In case replacement of one or more components is made necessary for clear defectiveness, please proceed with relevant claim before assembly.
3. Make sure to attentively follow the pictures of this manual to detect the proper position of the pieces during the assembly phase.
4. Make sure to stick to the instructions in this manual to guarantee perfect functionality and safety of the door.
5. **IMPORTANT : make the assembly on a horizontal, clean and smooth surface, taking care to place all the pieces with the numbered label upwards following the direction indicated on this manual.**

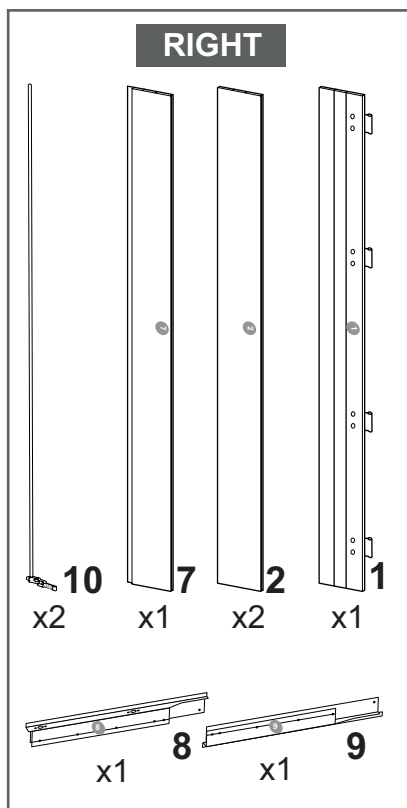
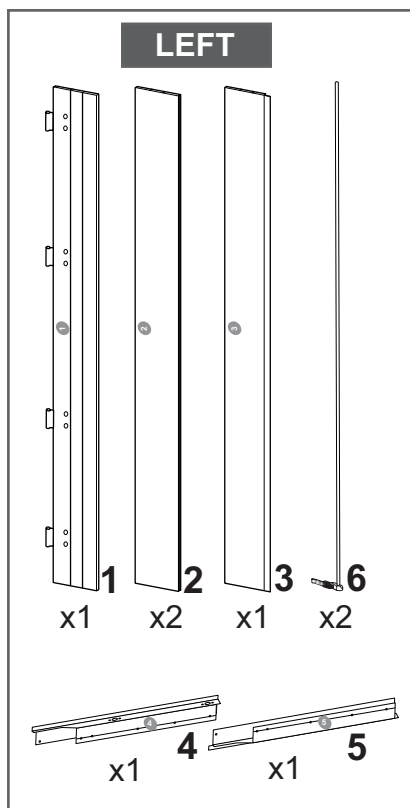
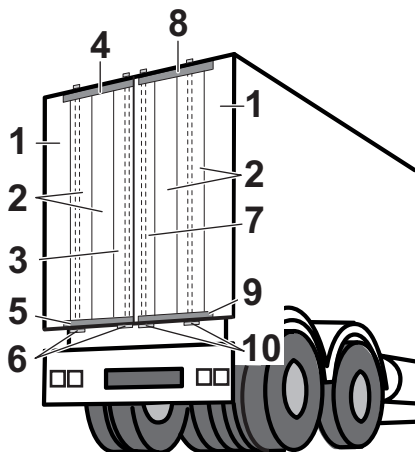
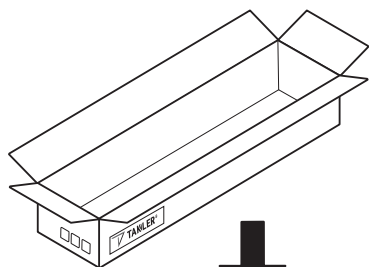

*"frontal view"*

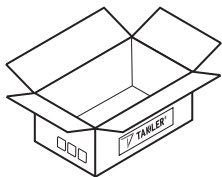

Ø 6,4xh14,5 mm



**A1**  
x52

Ø 6,4xh9 mm



**A2**  
x4



**B**  
x8



**C**  
x8

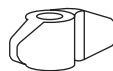

**D**  
x4

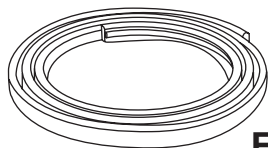

**E**  
x1

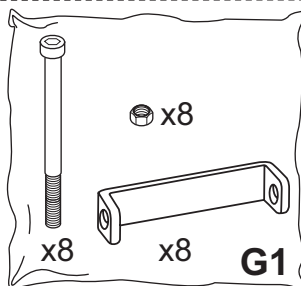

x8

x8

x8

**G1**



**F**  
x8



**H**  
x4



x4

**I**

**LEFT**

pages 6-14

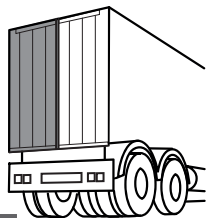

**RIGHT**

pages 16-25

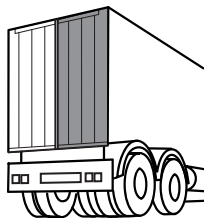

**16**

**1**

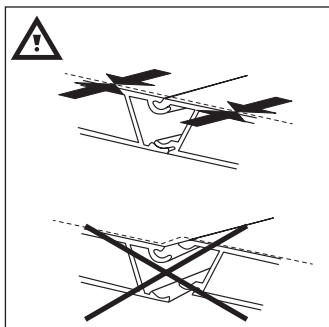
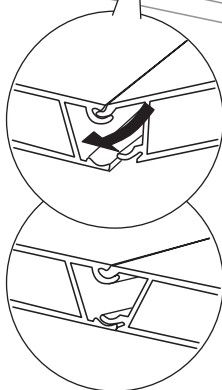
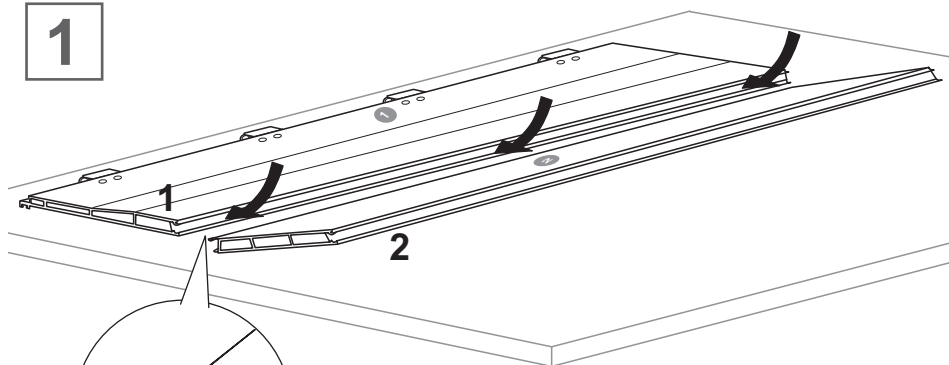

**1**

**2**

2

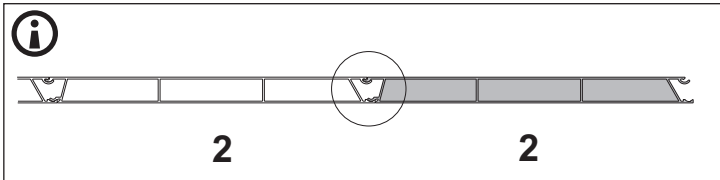
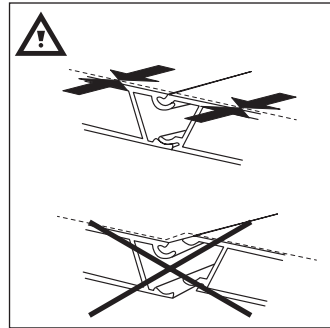
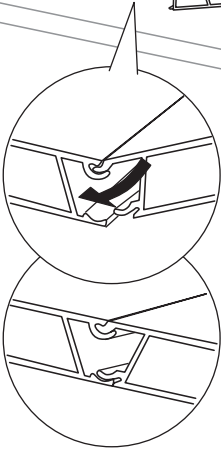
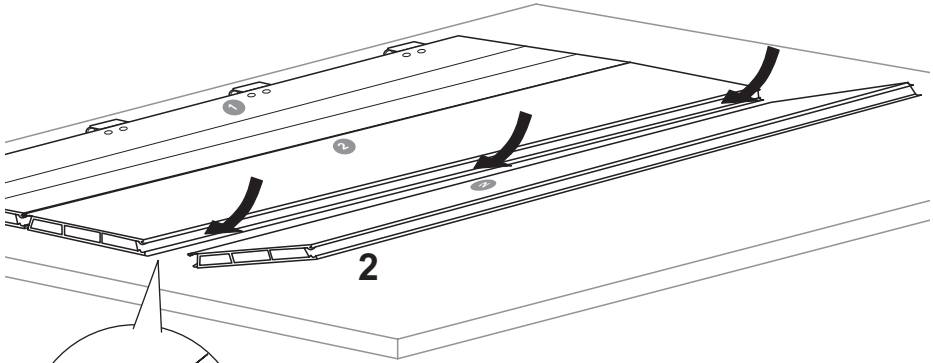

3

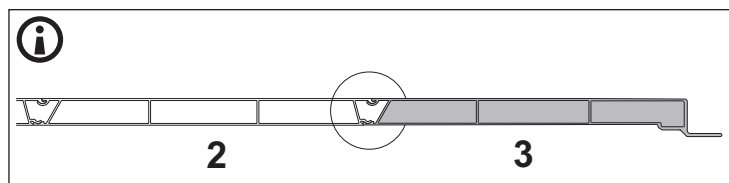
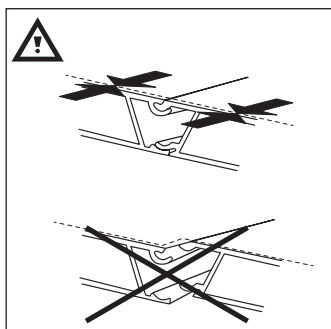
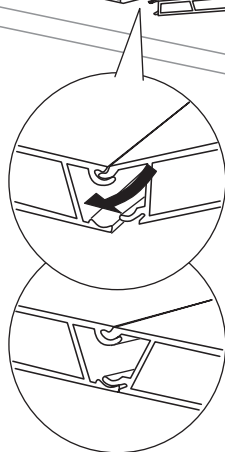
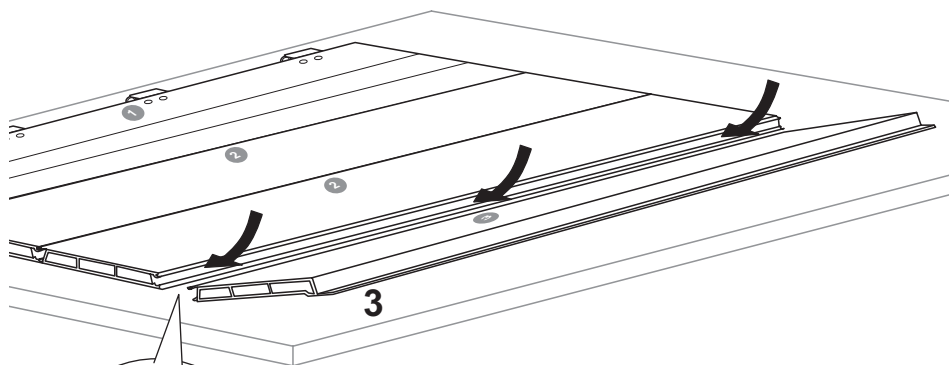



4

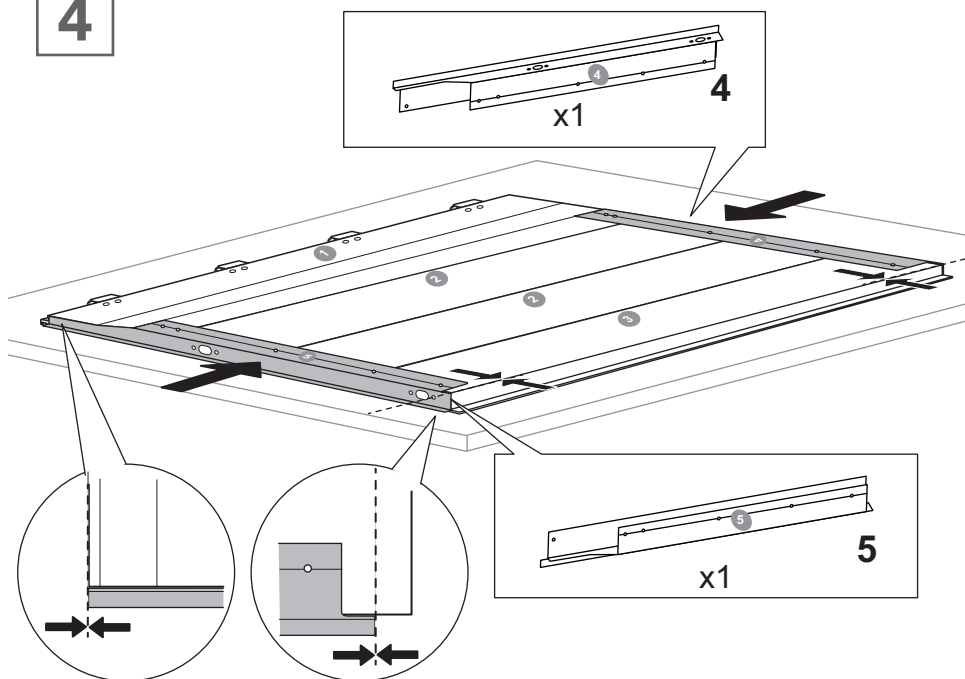

5

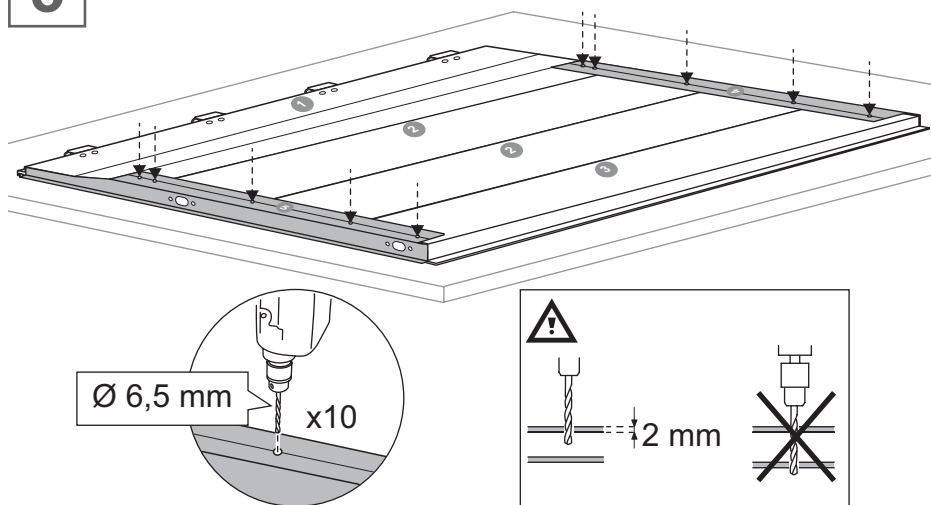

6

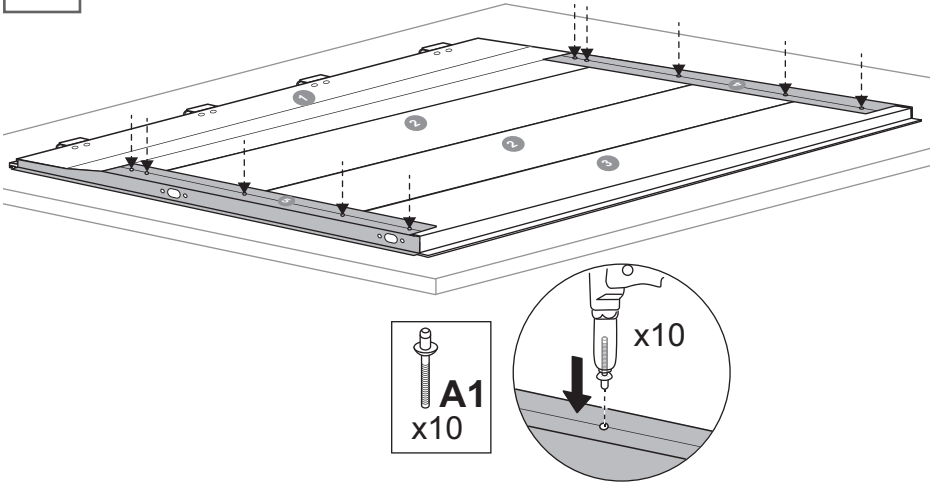

7

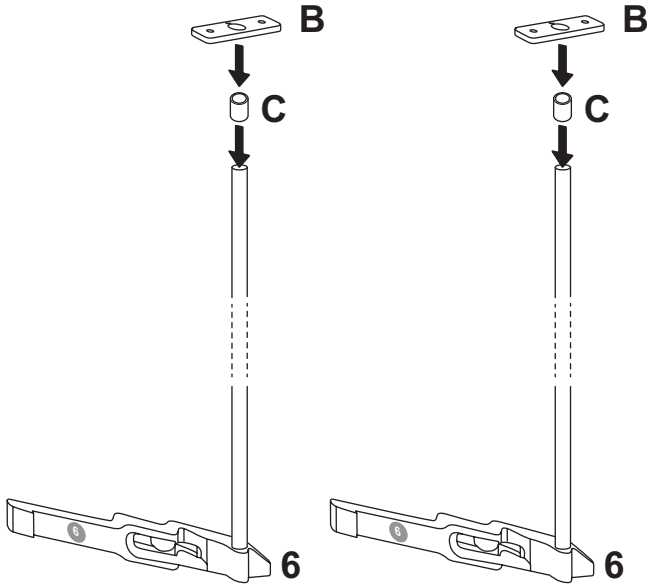

8

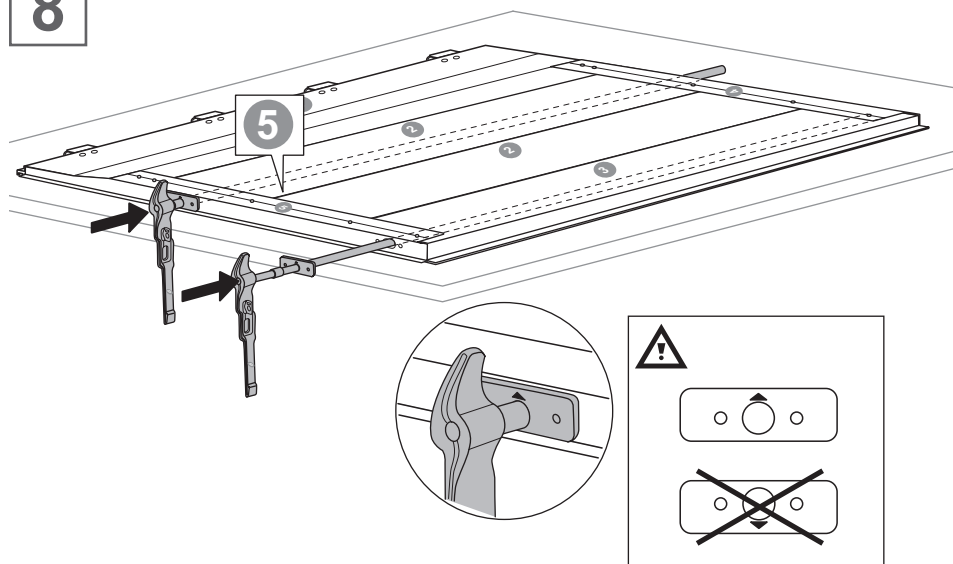

9

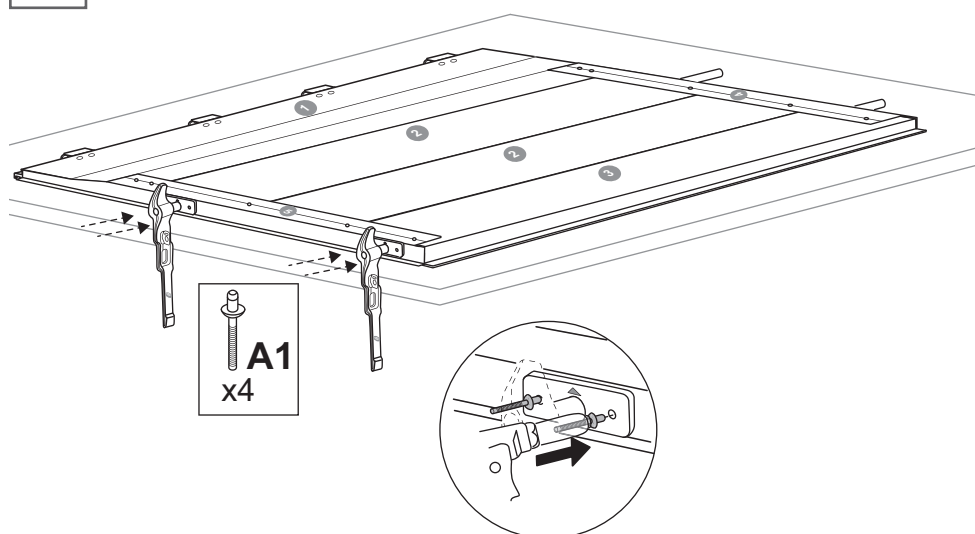

10

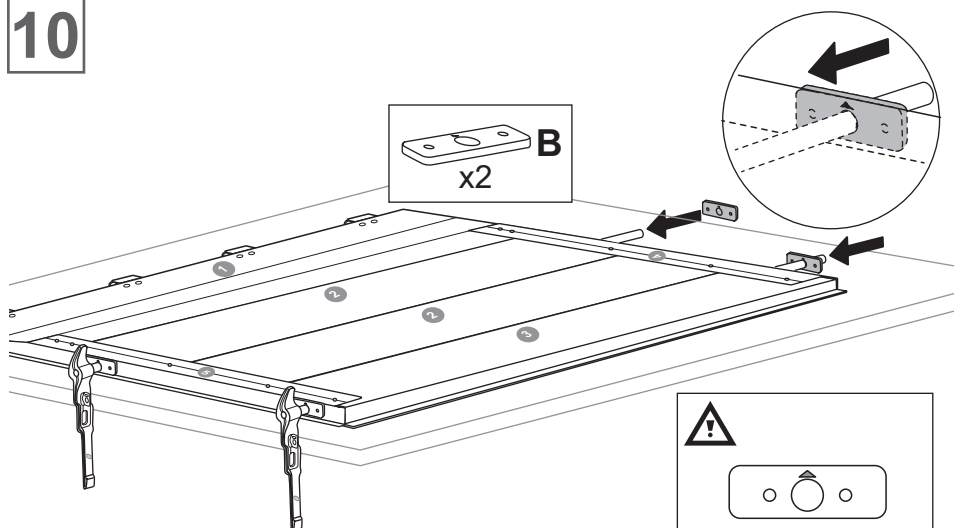

11

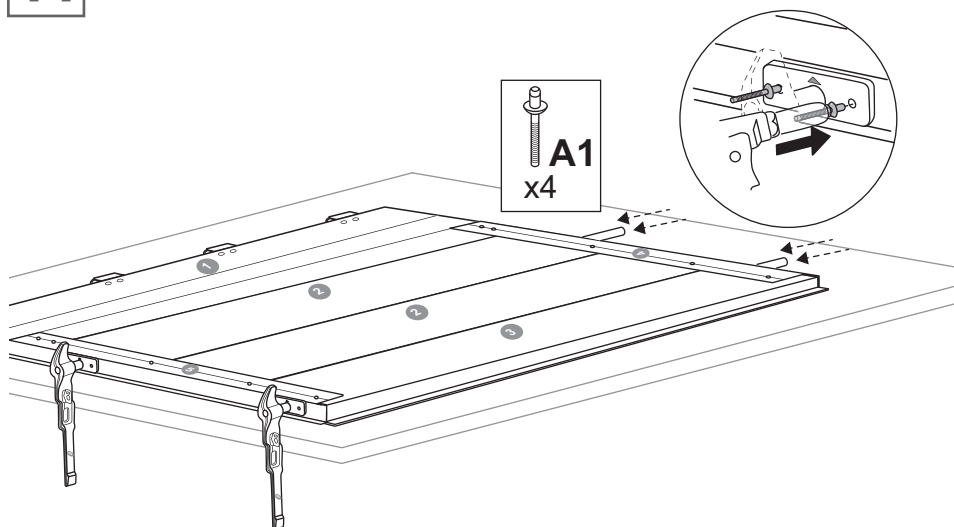

12

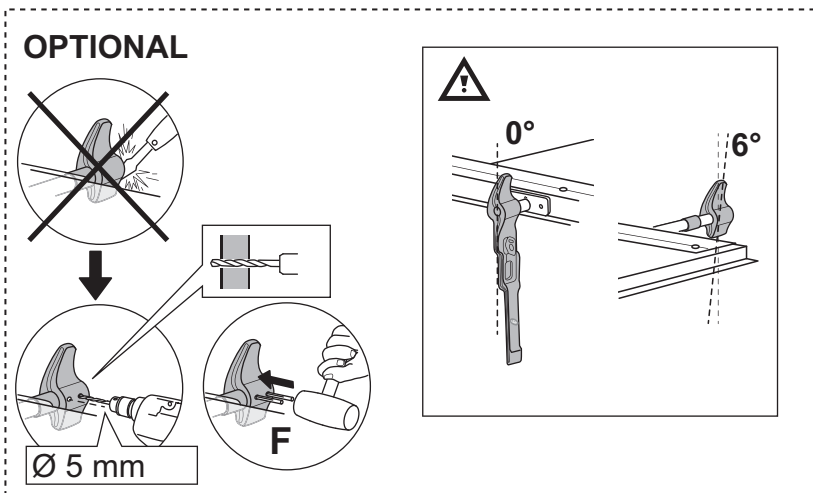
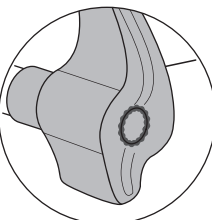
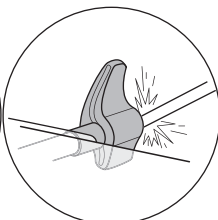
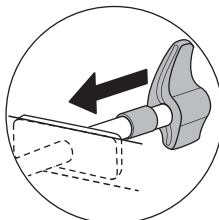
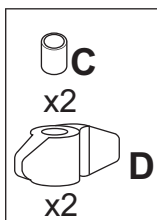
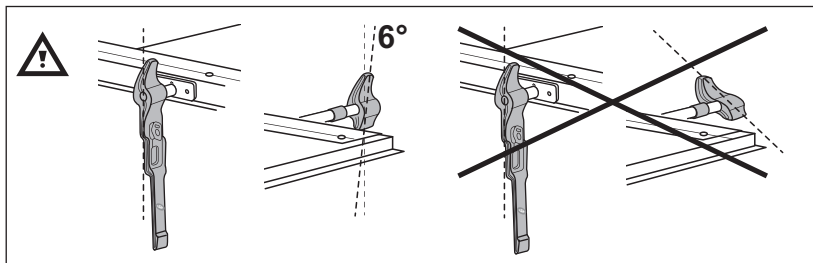
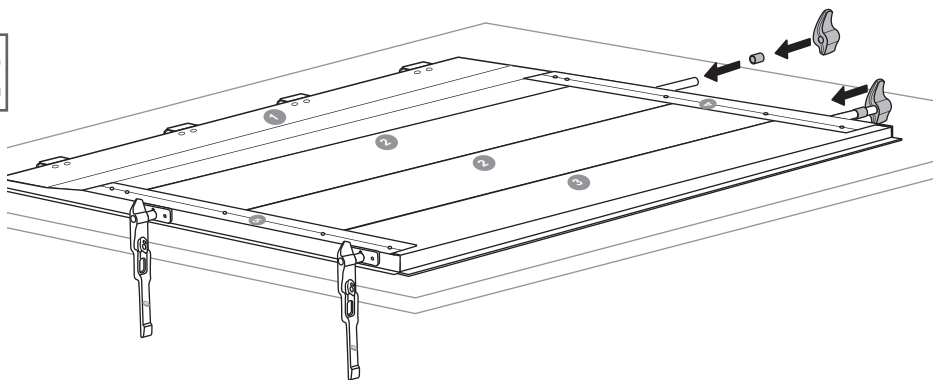

# 13

Rotate upside down

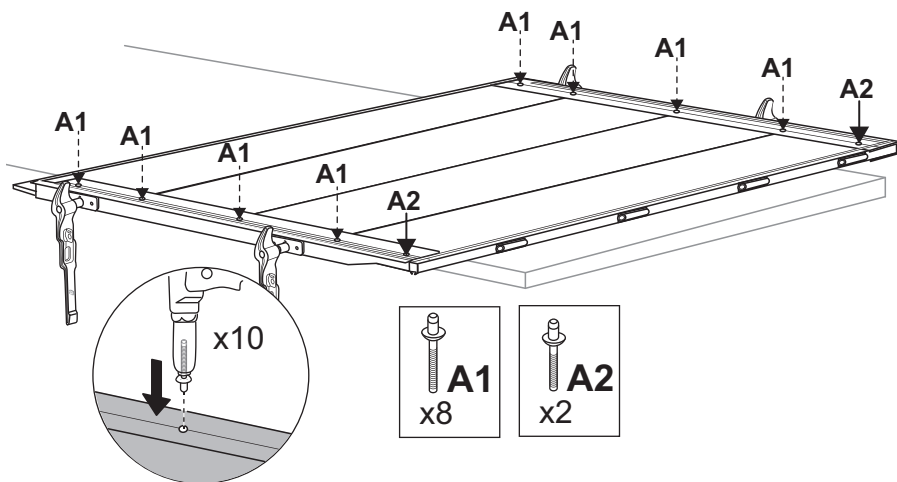
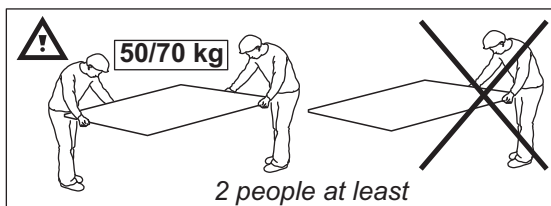
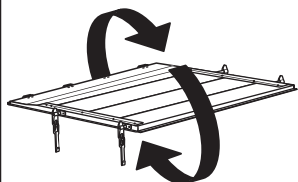

14

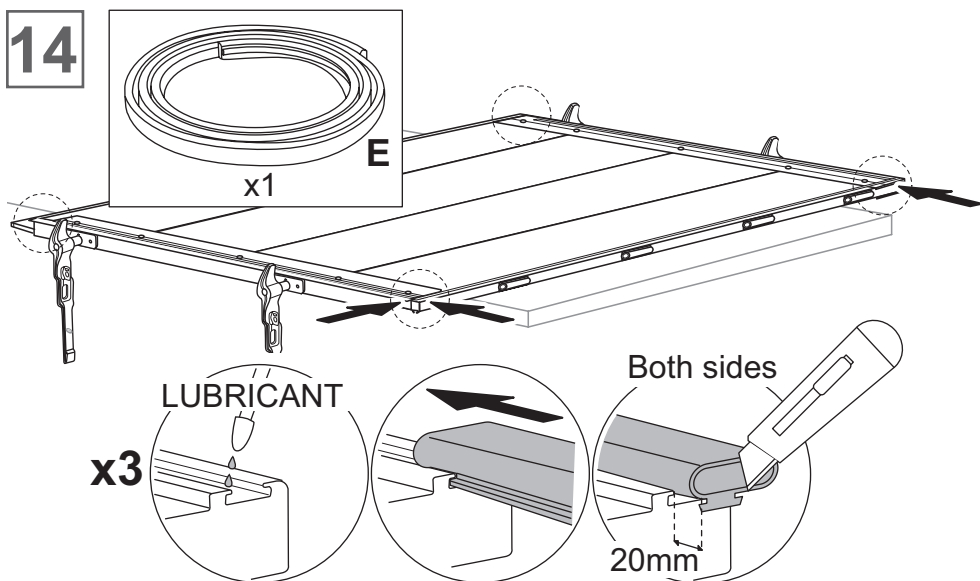

15

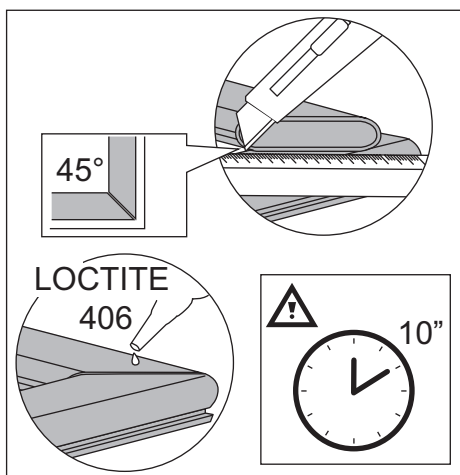
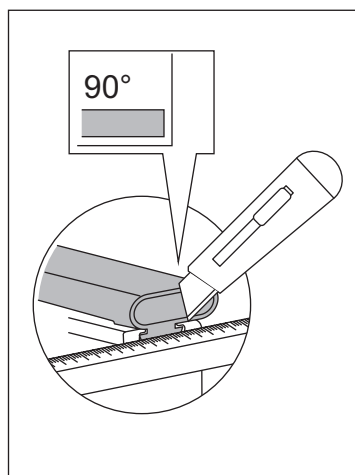
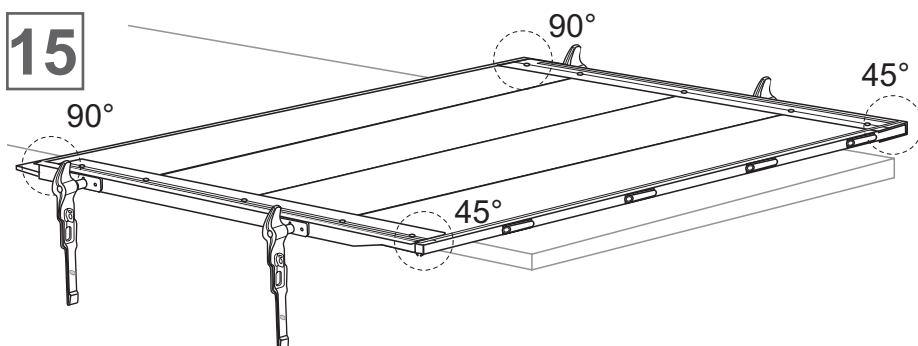

**RIGHT**

pages 16-25



**1**

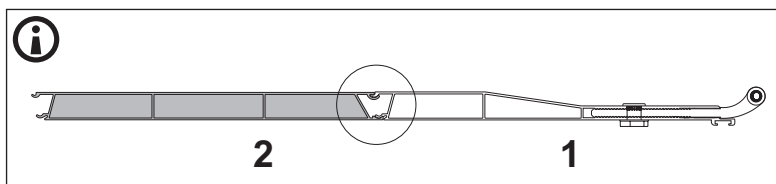
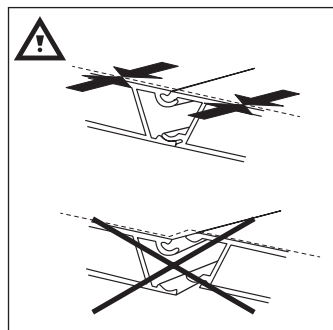
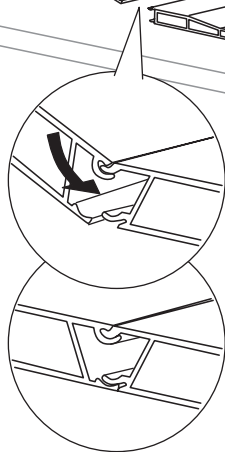
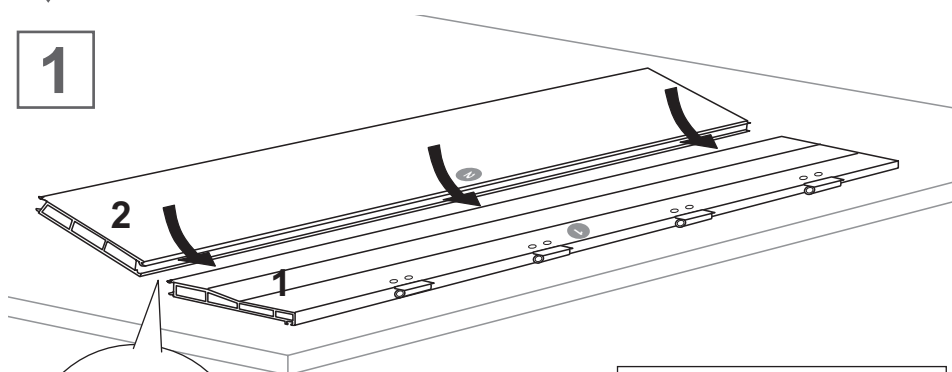



2

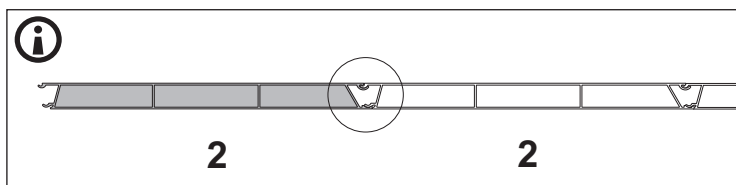
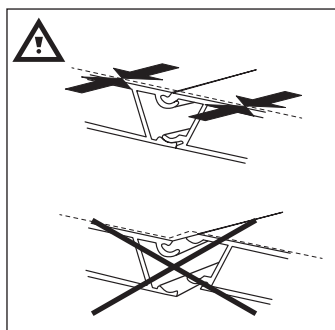
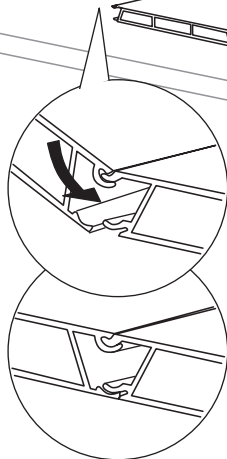
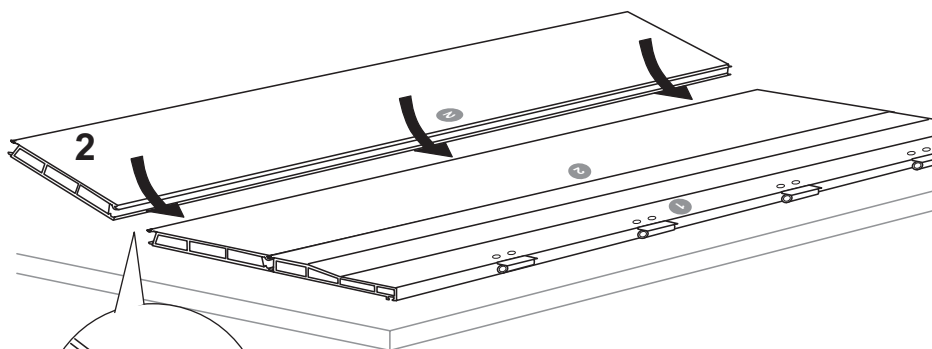

3

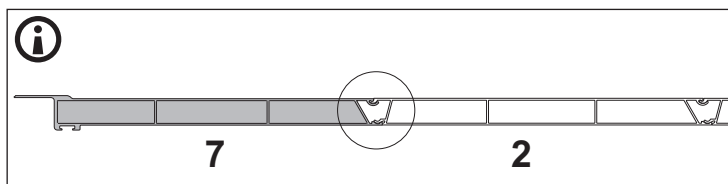
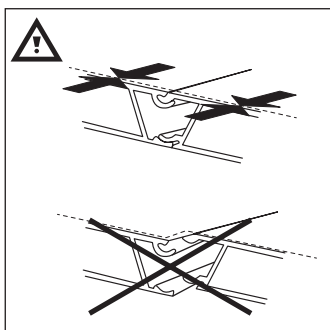
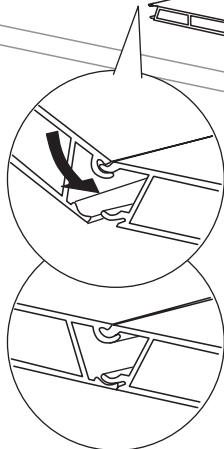
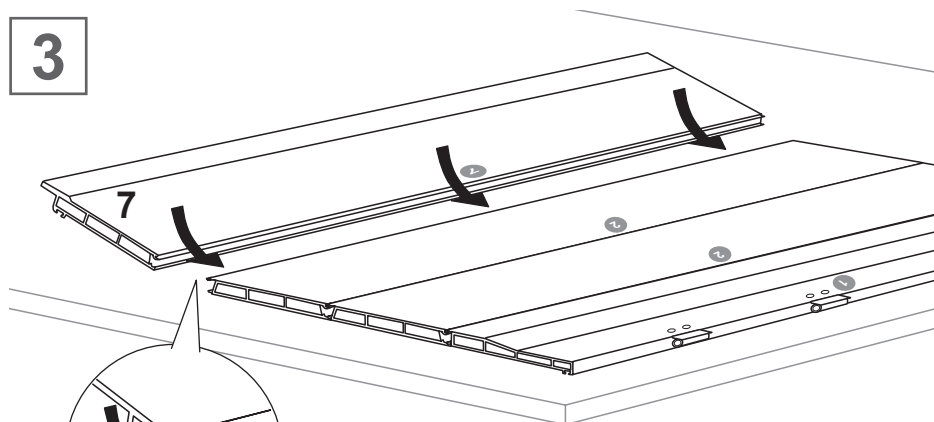

4

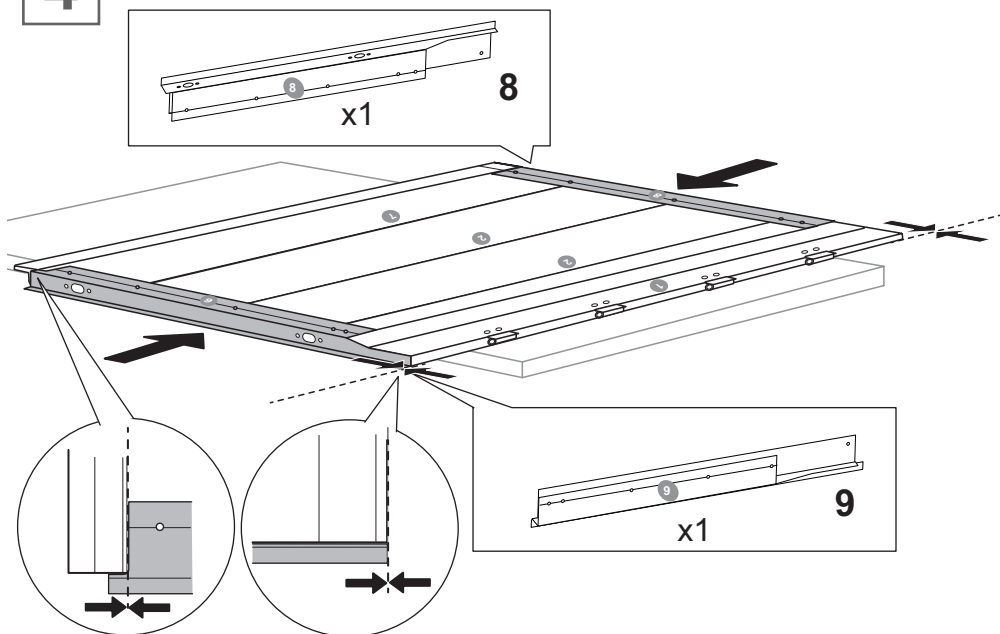

5

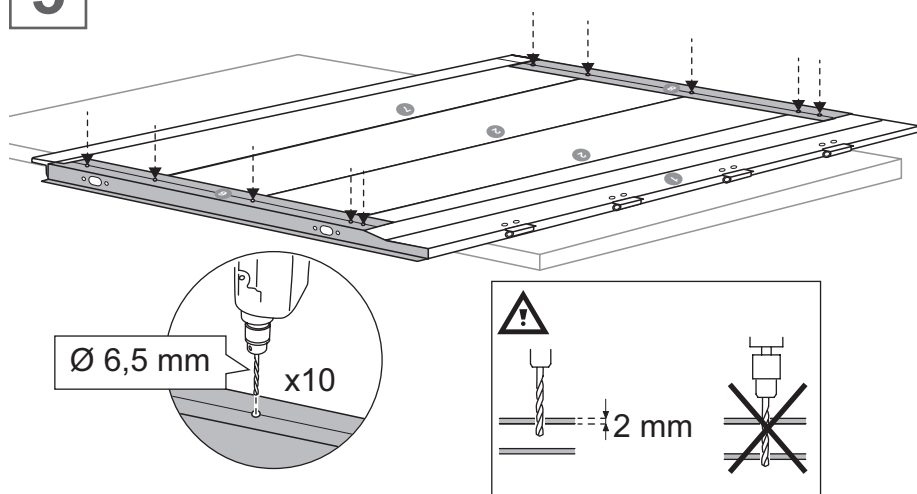

6

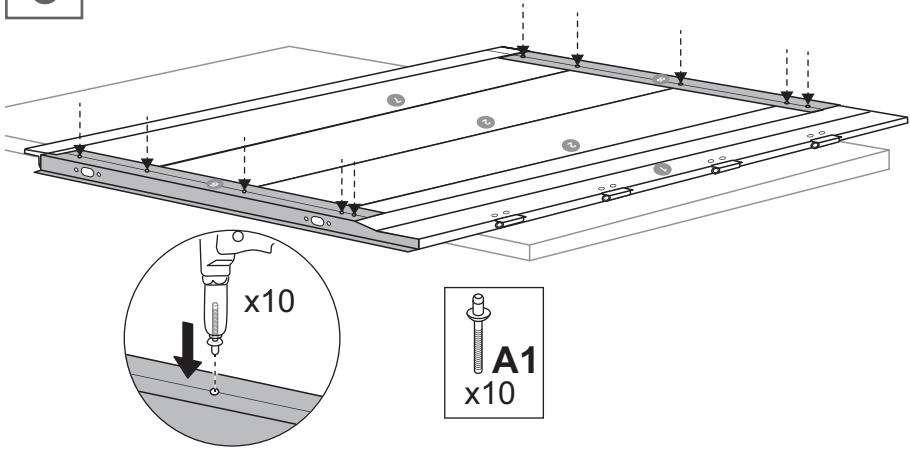

7

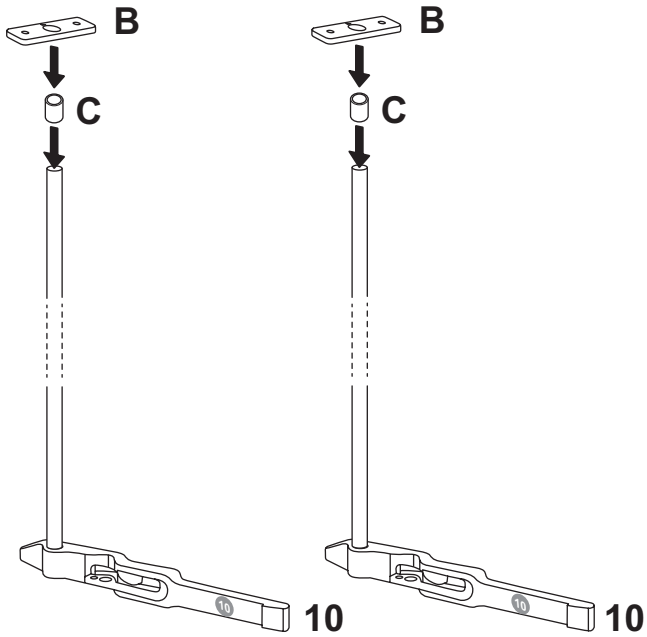

8

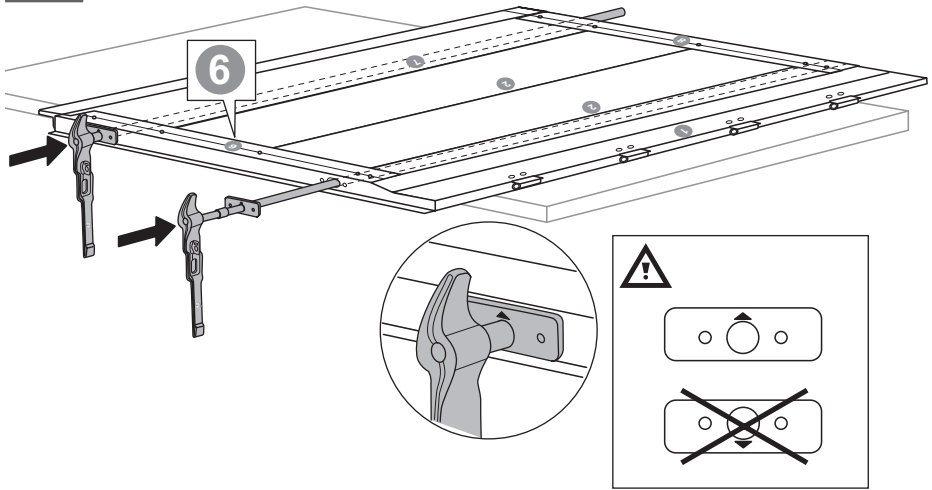

9

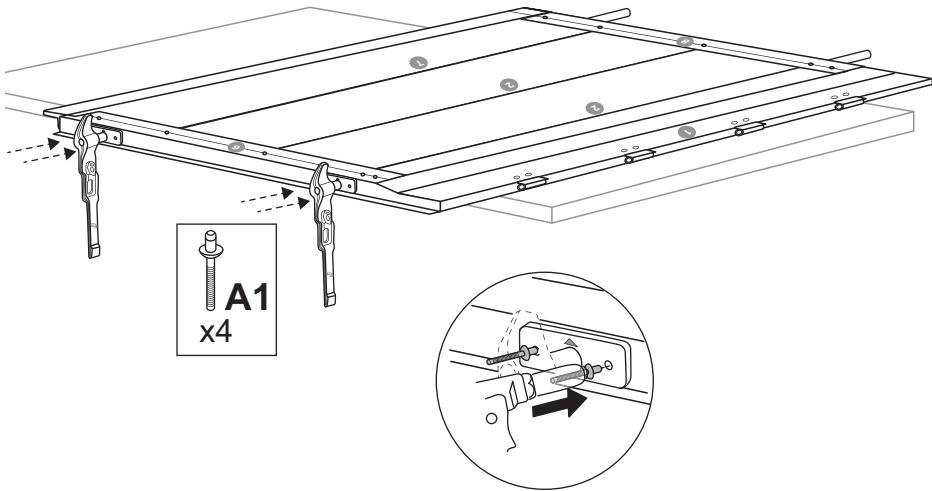

10

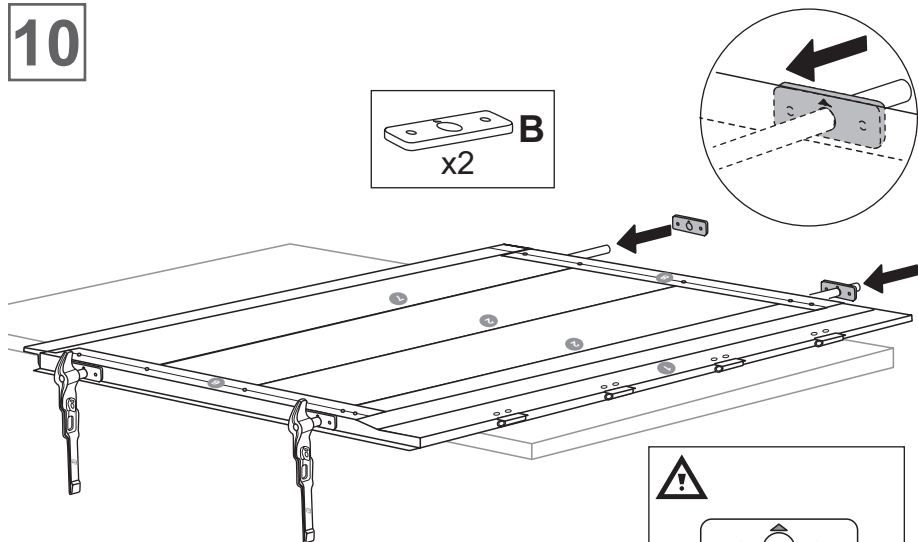

11

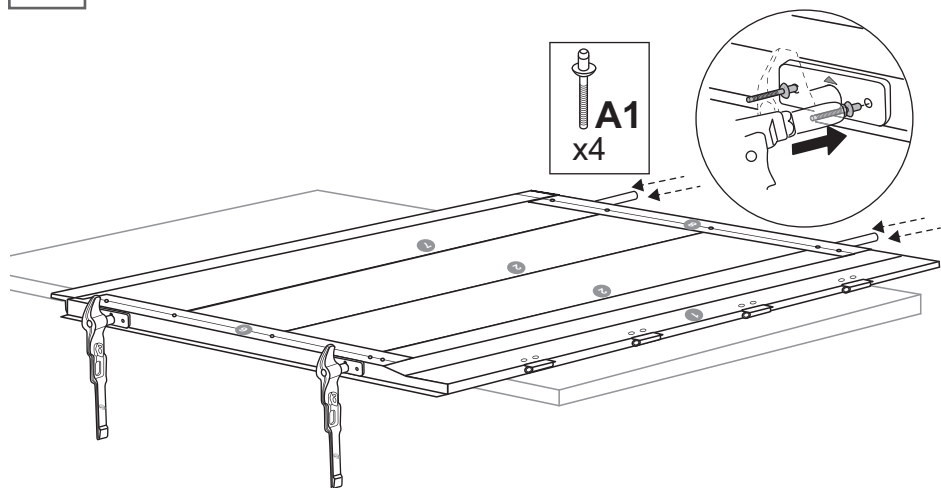

12

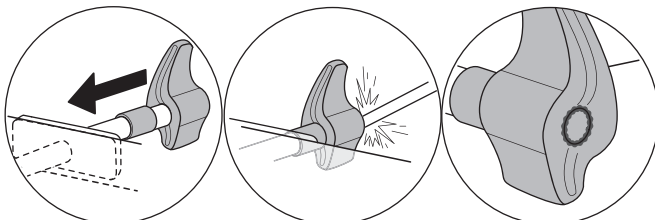
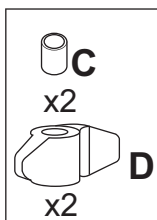
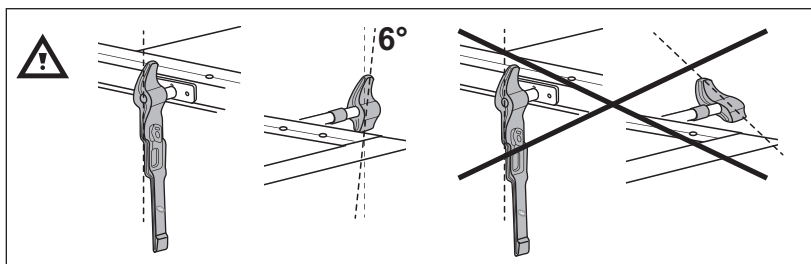
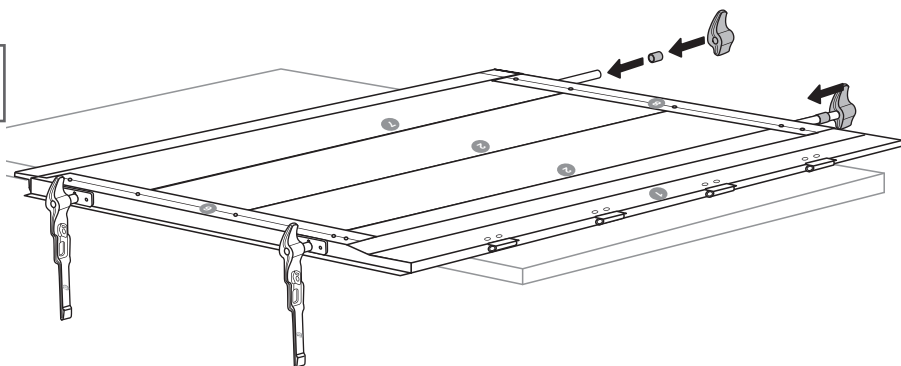

**OPTIONAL**

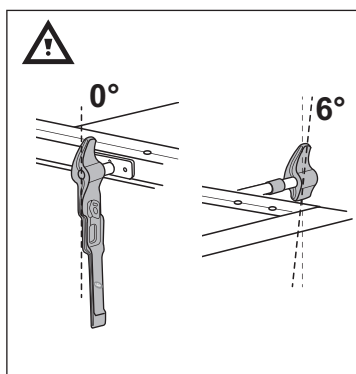
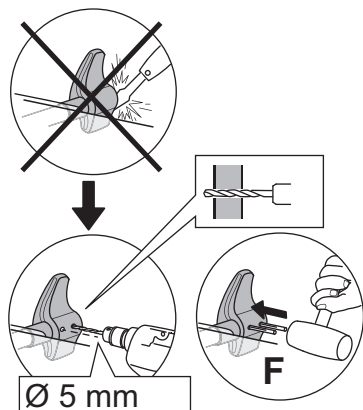

Rotate upside down

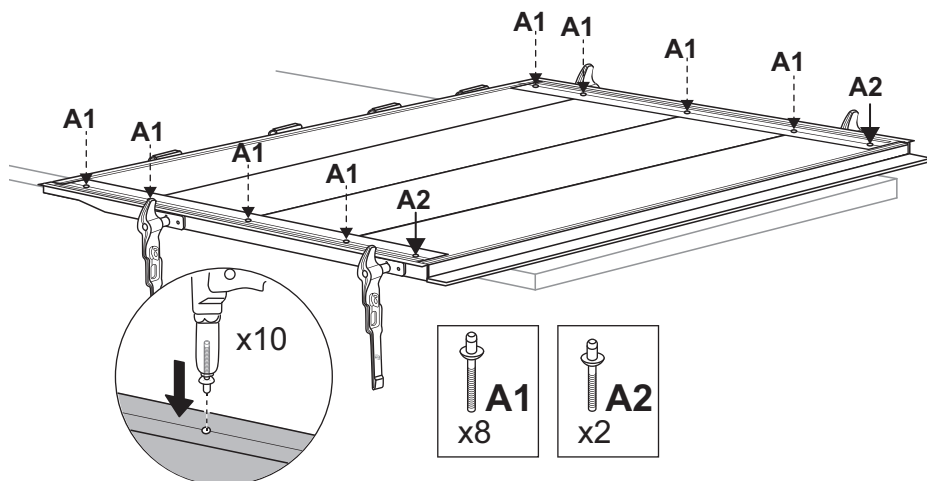
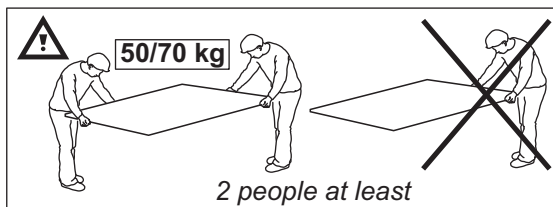
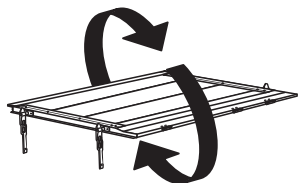



14

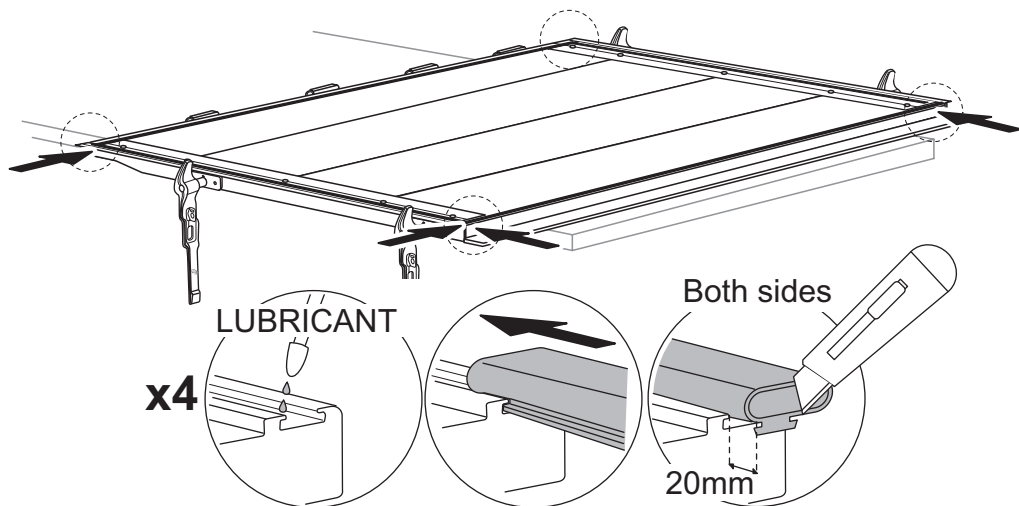
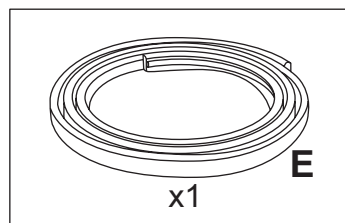

15

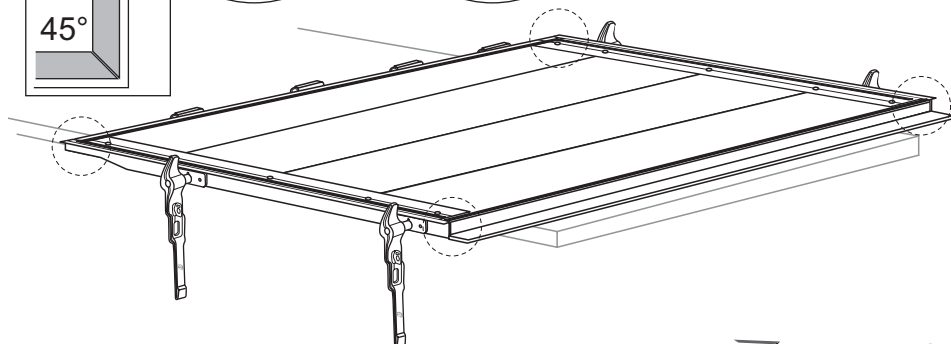
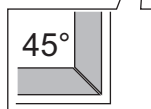
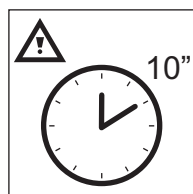
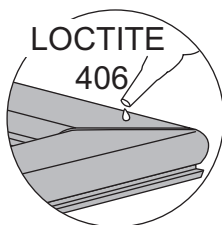
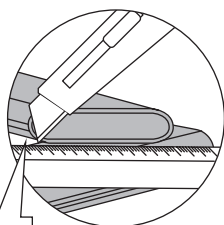

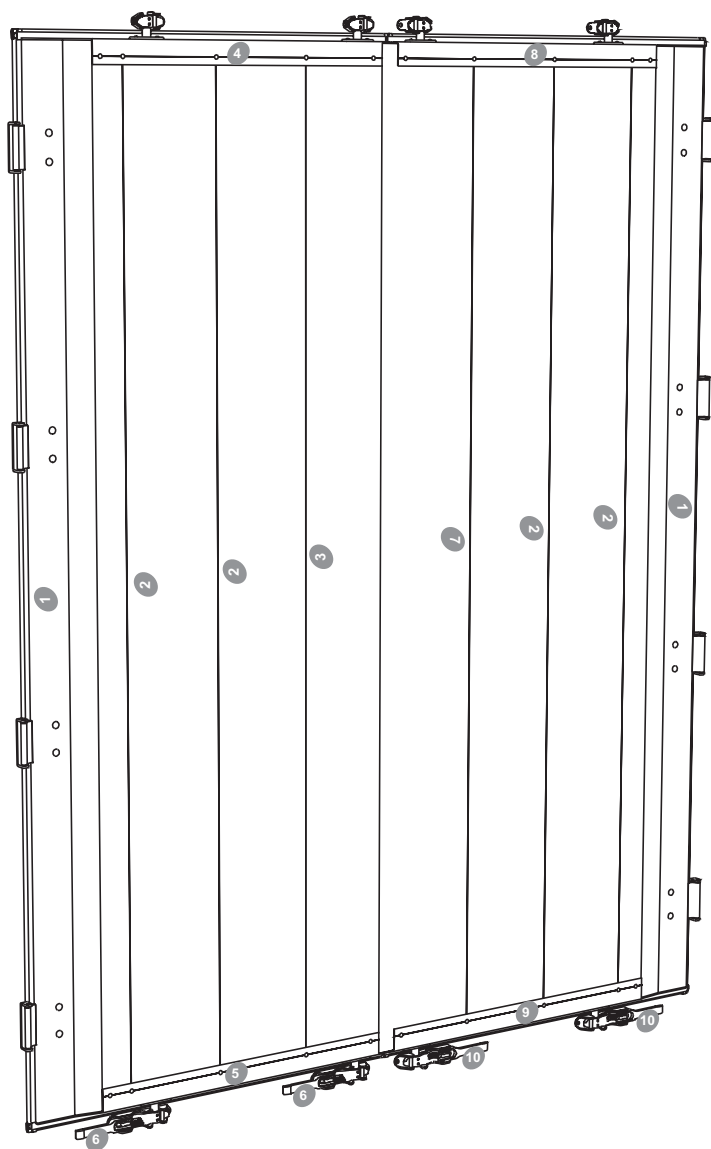





Takler SRL  
Via Appia Antica Km 13.100  
Zona Industriale Jesce  
75100 Matera • Italy

T +39 0835 25 19 11  
F +39 0835 25 19 66  
[info@taklergroup.com](mailto:info@taklergroup.com)

---

[TAKLERGROUP.COM](http://TAKLERGROUP.COM)

