

# INSTALLATION GUIDE

BT-62111M/62111S

Massage Bathtub

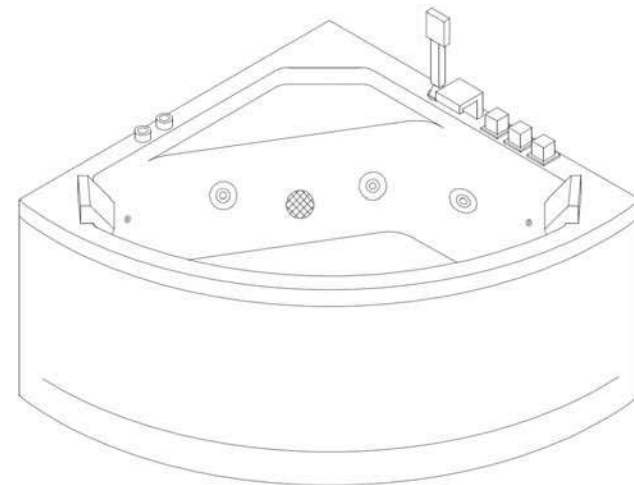

## 8. Problems & Suggestions:

Problems	Cause	Suggestions
Water Pump Failure	Disconnect with power supply, leakage protector disconnect	Connect the power supply, connect leakage protector
	Plug disconnected	Connect plug
	Electricity supply abnormal	Inspect electricity supply
	hose is loose	check the hose
	start switch broken	Change it
	Pump impeller is blocked by Rubbish	Clean the pump
	Water Pump broken	Repair or change it
Water pump OK but no water out of jets	Pump impeller slipped	Change the impeller
	Water recycle device jammed or recycle line leakage	Clear water recycle or repair the leakage
Failure to control massage Strength	regulating valve jammed	Clean it
	Voltage abnormal	Inspect the voltage
	Water recycle device jammed	Clean it
Bathtub surface uneven	Metal feet not balanced	Adjust the metal feet
Water pipe leakage	Seal failure	Change it
	Screw unlocked	Lock it
	Joint disconnected	Reconnect it

## 9. Caution:

- 9.1 Please check the above table first in case of any function failure.
- 9.2 The massage bathtub is used in a very humid environment. Although the manufacturer already considers the safety measures in production, the electrical installation should be conducted by qualified electrician. Meanwhile, a reliable leakage circuit-breaker must be used and ground wire should be connected.

# MESSAGE BATHTUB MANUAL MODEL:BT-62111M/BT-62111S

Thank you for choosing ORANS bathtubs. To secure safety, please read the instructions carefully before installation

## INDEX

CONTENT-----	1
Parts and Accessories-----	2
Electrical/Watery requirements-----	3
Water supply system installation-----	5
Bathtub installation-----	6
Operation manual -----	7
Maintenance-----	7
Safety instructions-----	7
Problems & Suggestions-----	8
Warnings-----	8

### Note:

This manual does not equal letter of quality guarantee. The contents of this manual are subject to change with products update and revision.

Before installation, please read carefully the electrical and watery requirements, and pre-set the connection to the water system and electricity system.

## 1. Parts and Accessories

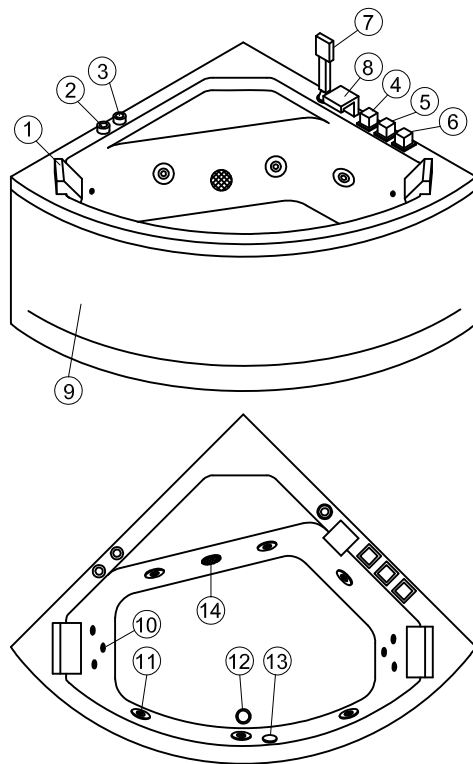

- |                |                    |                   |
|----------------|--------------------|-------------------|
| 1. pillow      | 2. start switch    | 3. Air regulation |
| 4. Hot water   | 5. Diverter        | 6. Cold water     |
| 7. Hand shower | 8. water inlet     | 9. Front panel    |
| 10. small jets | 11. big jets       | 12. drainage      |
| 13.overflow    | 14.backwater cover |                   |

## 5. Operation manual

Water massage:

1. When the water level is higher than the highest jet, use the C switch to start the pump.
2. During the massaging, use the D switch to control the massage power, we can lower the power while clockwise.

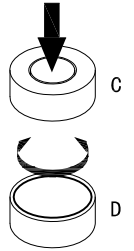

## 6. Cleaning and maintenance:

- 6.1 Clean with soft cloth and light detergent. Any detergent with acetone or ammonia elements is forbidden. It is also forbidden to use any sterilization solution that contains formyl and formaldehyde.
- 6.2 A scar or scratch on the surface can be first polished by 2000# wet sandpaper, then applied with toothpaste and then finally cleaned and polished by soft cloth.
- 6.3 The lime scale or dirt on the surface can be cleaned up with light acid detergent, such as lemon juice, heated wax with soft cloth wiped.
- 6.4 The backflow cover can be taken off to clean in case getting stuff or dirty.
- 6.5 Chromed parts need not wiping too often.
- 6.6 Don't use a rough tool or sanded detergent with chemical dissolvent to clean the bathtub.
- 6.7 Drain water completely and power off after use
- 6.8 Don't strike or scratch the surface. Avoid any burning cigarette or hot stuff above 70°C touching the surface.
- 6.9 Massage system cleaning: fill the bathtub with 40°C warm water, pour in detergent at rate of 2 gram per liter of water, start massage system, turn it off after 5 mins, drain the water. Then fill the bathtub with cold water, start massage system, turn it off after 3 mins, drain the water, and finally clean the bathtub.

## 7. SAFETY INSTRUCTIONS:

- 7.1 Electric components should be installed by professional electrician under the guide of this manual.
- 7.2 Electric parameters should be conformable with national standards. The power wire should have leakage protector and be connected with ground wire. The switch, plug and socket should be water proof.
- 7.3 Don't use too hot water. When filling the bathtub, cold water should be ahead of hot water. Don't start water pump until water level reaches the jets.
- 7.4 Cut off power after use.
- 7.5 The duration use of the massage is better to be controlled within 30mins.

### 3. 2. 2 Drainage

Adjust screws of the bottom stands to balance bathtub body.  
Connect the bathtub drainage with the drainage pipe, and then connect the pipe with ground drainage hole. Apply glue as well.  
As shown in below diagram.

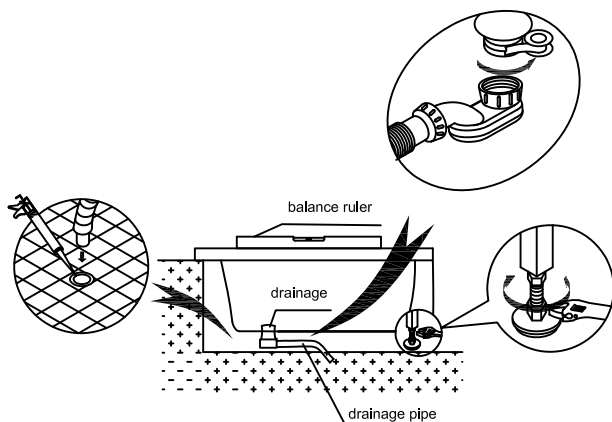

## 4、 Bathtub installation :

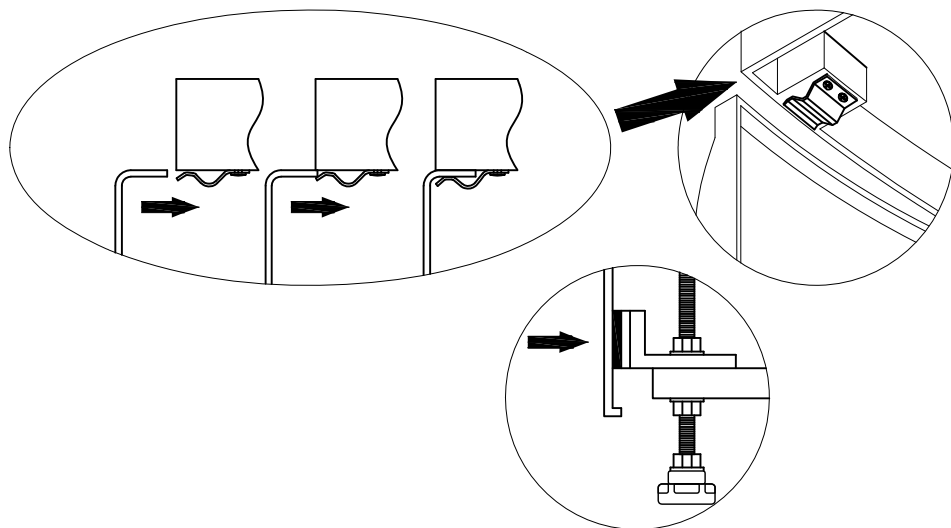

## 2.Electrical/Watery requirements

- 2.1 Power switch facility: install small circuit-breaker with 32A water proof and leakage protection in the easy-operating place. Turn off the power switch after use to protect the computer system of the product (that is: the position “A” in the following picture)
- 2.2 Power supply: 220V/50Hz,10A waterproof, 2.5 square mm three-core copper wire. The power socket must be towards the outside possible for future easy maintenance. (that is the position “B” in the following picture )
- 2.3 Water supply: connect hoses(G1/2 male connector) marked with cold or hot water supply respectively. Shut-off Valve should be installed at the end of water supply pipe on the wall. ( that is the position “C” in the following picture)
- 2.4 Drain: The drainage should be just right to the drainage point on the ground as shown on below picture. If not, it has to be within 200mm distance from the point. The diameter of sewage pipe should be 50mm or more. (that is the position “D” in the following picture)
- 2.5 Maintenance area: Please leave space 500mm or more around the bathtub for future maintenance. Please do not install any fixed objects in this free area. ( that is the shadow in the following picture)

### Note:

The water pressure of this product must be between 0.1--04MPA. It may influence the function of the product if out of this range.  
Please install the booster pump if water pressure is too low (please prepare the booster pump by yourself).

## ELECTRICAL SPECIFICATIONS

Appliance Name	Rated Voltage	Rated Hertz	Rated Watt
Water pump	AC220V/230V	50Hz	1125W

## ELECTRICAL SPECIFICATIONS

### Electrical/Watery Diagram

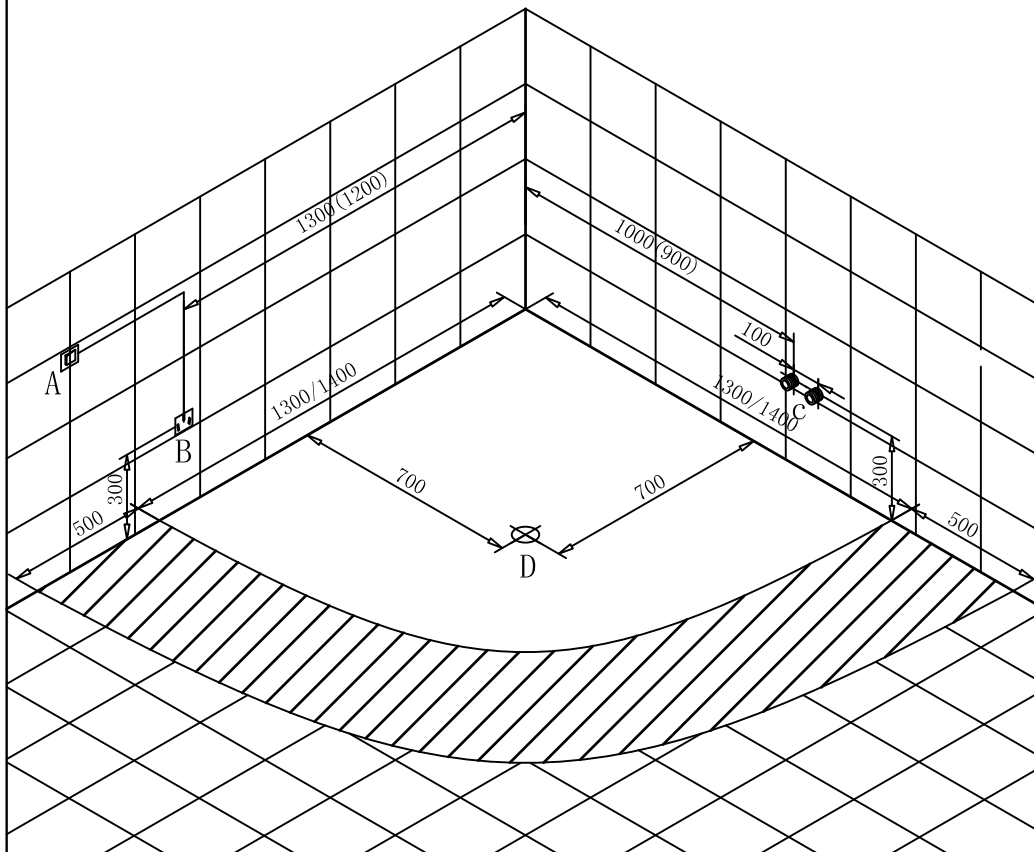

The power cable should be installed with leakage protector and connected to the ground. The cross section area of power cable should at least 2.5 square mm or above. The power supply facility should conform to national safety standard (please prepare the leakage protective switch by yourself), and the protective ground wire should be connected with the massage bathtub iron hob, where there is a symbol for ground wire.

## 3. Water supply system installation

### 3.1 Water supply diagram

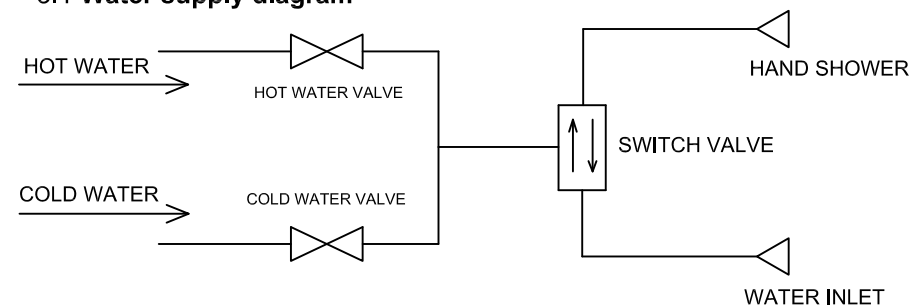

### 3.2 Pipe connection

#### 3.2.1 Water supply

The parts have been assembled in factory, so you only need to connect the cold and hot water hose with corresponding water pipes or connectors. The connection joints are better to be placed in the back invisible area of the bathtub.

