

Our products are designed to be used correctly and with care for the purpose for which they are intended. No liability is accepted by the Tool Connection for incorrect use of any of our products, and the Tool Connection cannot be held responsible for any damage to personnel, property or equipment when using the tools. Incorrect use will also invalidate the warranty.

If applicable, the applications database and any instructional information provided has been designed to offer general guidance for a particular tool's use and while all attention is given to the accuracy of the data no project should be attempted without referring first to the manufacturer's technical documentation (workshop or instruction manual) or the use of a recognised authority such as Autodata.

It is our policy to continually improve our products and thus we reserve the right to alter specifications and components without prior notice. It is the responsibility of the user to ensure the suitability of the tools and information prior to their use.



Safety First. Be Protected.



5 018341 075255 >

7525_Instructions_V2

Guarantee

If this product fails through faulty materials or workmanship, contact our service department direct on: **+44 (0) 1926 818186**. Normal wear and tear are excluded as are consumable items and abuse.

www.lasertools.co.uk



Distributed by The Tool Connection Ltd

Kington Road, Southam, Warwickshire CV47 0DR
T +44 (0) 1926 815000 F +44 (0) 1926 815888
info@toolconnection.co.uk www.toolconnection.co.uk

LASER®

Diesel Injector Remover VAG TDi

Instructions



Components

This tool kit is made up of a pair of bolt-on injector adaptors and small slide hammer. It is designed to be used to help extract VAG Common Rail diesel injectors with the minimum of disassembly. The kit is equivalent to VAG OEM tools T10402 and T10415.

(No solenoid removal required).

For seized injector removal please use Laser 6263 Extractor with Air Hammer.

Note: Check OEM data to confirm application.

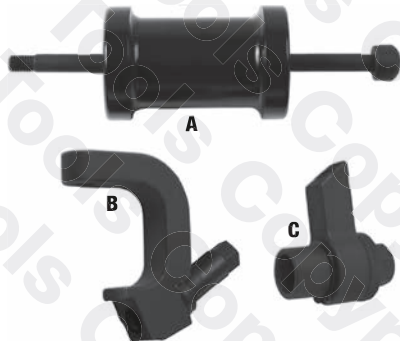

Ref	OEM	Description
A		Slide Hammer
B	T10402	Injector Adaptor and Fixing (piezo Injector 1.6 common rail etc.)
C	T10415	Injector Adaptor and Fixing (2.0L common Rail engines etc.)

Applications

Make	Model	Year	Type
Audi	A3	2009/2013	TDi CR
Seat	Ibiza	2008	
	Altea	2009	
	Altea XL	2009	
	Altea Freetrack	2009	
	Leon	2009	
	Toledo	2013	
Volkswagen	Golf	2009	

Engine	Code
1.6	TDi CR diesel
2.0	TDi

The following instructions are for guidance only. Please refer to OEM derived data such as the vehicles manufactures own data or Autodata.

The use of this injector puller kit is purely down to the user's discretion and Tool Connection cannot be held responsible for any damage caused what so ever.



Instructions

NOTE:

- Before removing injector pipes and injectors ensure the working area is clean to prevent dirt from entering the fuel system/engine cylinder.
- Block off any open pipes
- Select appropriate adaptor (B or C) according to OEM specification and assemble as shown.

N.B: these instructions are for guidance only. The Tool Connection Ltd. Strongly advises the use of OEM instructions and applications information.

Assembly of A and B

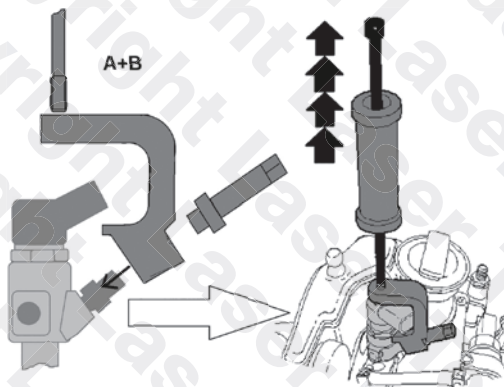

Assembly of A and C

