



# FITTINGS FOR MULTILAYER, PEX AND POLYBUTYLENE PIPE

## 510 Multi-Fit® fitting for multilayer, PEX and polybutylene pipe

Available size with 1/2" nut

Available size with 3/4" nut EUROKONUS

Available size with 1" nut



### 510 available size with 1/2" nut

SIZE	CODE	PACKING
14x2	510001214200	20/180
16x2	510001216200	20/180
16x2,25	510001216225	20/180
18x2	510001218200	15/135
20x2	510001220200	15/135
20x2,25	510001220225	15/135
20x2,5	510001220250	15/135

### 510 available size with 3/4" nut EUROKONUS

SIZE	CODE	PACKING
16x2	510003416200	20/140
18x2	510003418200	15/105
20x2	510003420200	15/105
20x2,25	510003420225	15/105
25x2,5	510003425250	10/70
26x3	510003426300	10/70

### 510 available size with 1" nut

SIZE	CODE	PACKING
25x2,5	510010025250	10/110
26x3	510010026300	10/110
32x3	510010032300	10/70

## CERTIFICATIONS



## TECHNICAL SPECIFICATIONS

PATENTED

Nut in nickel-plated brass.

Tail in brass.

Maximum working pressure: 20 bar.

Threads: ISO 228 (equivalent to DIN EN ISO 228 and BS EN ISO 228).

Minimum and maximum working temperature: -20°C, 110°C.

The fittings are supplied with an o-ring for conical seats and a flat washer for flat seats.

KIWA certified fitting only with o-ring for conical seats.



# FITTINGS FOR MULTILAYER, PEX AND POLYBUTYLENE PIPE

## OVERALL DIMENSIONS

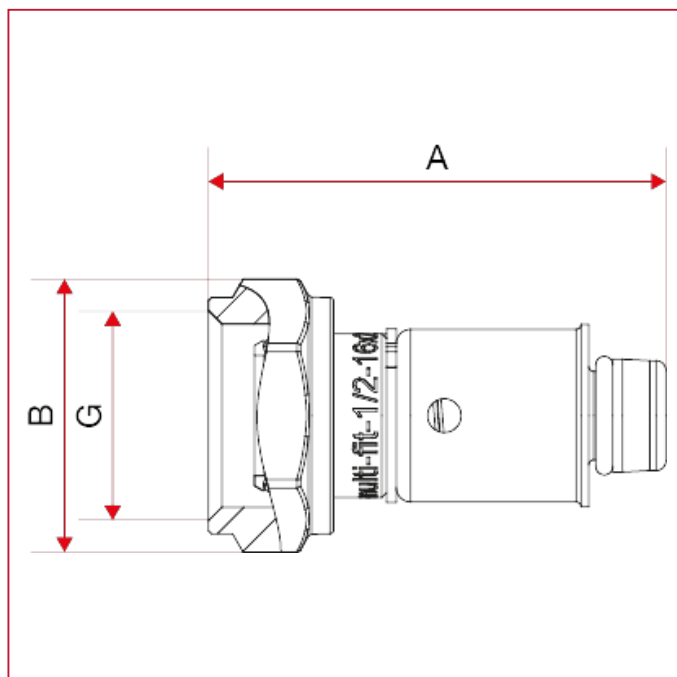

### 510 available size with 1/2" nut

	14x2	16x2	16x2,25	18x2	20x2	20x2,25	20x2,5
A	28,3	28,3	28,3	28,3	28,3	28,3	28,3
B	46	47,5	47,5	46	46	46	46
G	1/2"	1/2"	1/2"	1/2"	1/2"	1/2"	1/2"
Kg/cm2 bar	20	20	20	20	20	20	20
LBS - psi	290	290	290	290	290	290	290

### 510 available size with 3/4" nut EUROKONUS

	16x2	18x2	20x2	20x2,25	25x2,5	26x3
A	33	33	33	33	33	33
B	48,5	47	47	47	52	52
G	3/4"	3/4"	3/4"	3/4"	3/4"	3/4"
Kg/cm2 bar	20	20	20	20	20	20
LBS - psi	290	290	290	290	290	290

### 510 available size with 1" nut

	25x2,5	26x3	32x3
A	40,5	40,5	40,5
B	58,5	58,5	63
G	1"	1"	1"
Kg/cm2 bar	20	20	20
LBS - psi	290	290	290



## FITTINGS FOR MULTILAYER, PEX AND POLYBUTYLENE PIPE

### MATERIALS

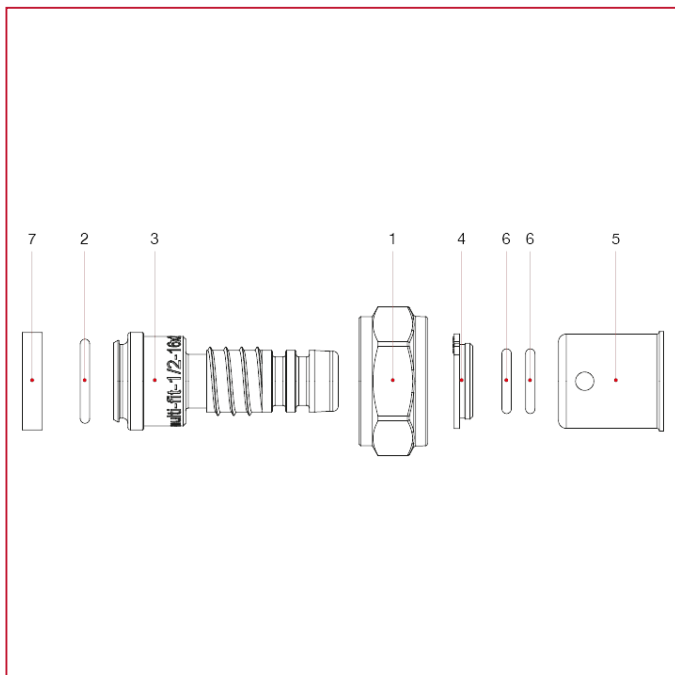

POS.	DESCRIPTION	N.	MATERIAL
1	Nut	1	Nickel-plated brass CW617N
2	O-ring	1	EPDM
3	Union	1	Brass PTL CW617N
4	Ring	1	Nylon
5	Outside liner	1	Stainless steel AISI 304
6	O-ring	1	EPDM
7	Washer	1	NBR



# FITTINGS FOR MULTILAYER, PEX AND POLYBUTYLENE PIPE

## INSTRUCTIONS



### FOUR SIMPLE STEPS FOR A SAFE INSTALLATION

1. Cut the pipe by a pipe cutter.
2. Deburr the inner side of the pipe.
3. Insert the fitting into the pipe.
4. Once the threaded part of the fitting reaches the pipe, screw the tail into the pipe as far as the thread has completely entered the pipe.

THE CONNECTION IS SAFE AND EASILY REVERSIBLE.

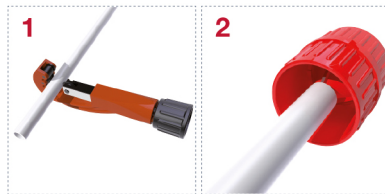
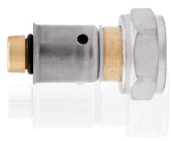

### ADVANTAGES:

- NO NEED TO REAM THE PIPE
- FIT FOR EVERY KIND OF MULTILAYER PIPE
- THE CONNECTION IS REVERSIBLE
- SUITABLE FOR SANITARY AND HEATING PLANTS
- NO NEED TO PRESS. NO NEED TO TIGHTEN. NO SPECIAL EQUIPMENT IS REQUIRED FOR THE INSTALLATION



The fittings are supplied with an o-ring for conical seats and a flat washer for flat seats.



### MANIFOLD WATER DISTRIBUTION SYSTEM

The Multi-fit® system is completed with the installation of the distribution manifold Art. 465 and built-in box Art. 499. This lay-out allows the planning engineer and installer to work in complete safety, also ensuring high quality system standards.



## FITTINGS FOR MULTILAYER, PEX AND POLYBUTYLENE PIPE

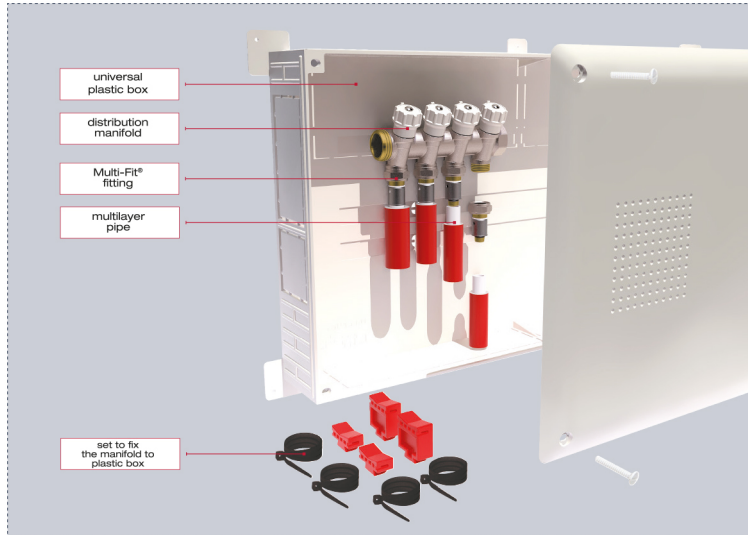

### ADVANTAGES:

- NO MORE BUILD-IN TEE AND ELBOW JUNCTIONS
- NO MORE LEAKAGES
- REALLY MAKE THE MOST OF MULTILAYER PIPING FLEXIBILITY AND INSTALLATION SPEED
- IMPROVE THE WATER FLOW
- MAKE REPAIRS EASY AND FAST
- EACH ENDPOINT CONNECTED TO A SINGLE MANIFOLD OUTLET

### USE OF THE FITTINGS FOR MULTILAYER, PEX AND POLYBUTYLENE PIPE



## FITTINGS FOR MULTILAYER, PEX AND POLYBUTYLENE PIPE

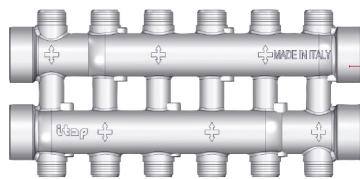

885

DUAL DISTRIBUTION MANIFOLD.  
1/2" male outlets, conical seat



850

DISTRIBUTION MANIFOLD  
MADE OUT OF BRASS BAR.



518

MALE/MALE ADAPTER



852

DISTRIBUTION MANIFOLD IN STAINLESS STEEL



518

MALE/MALE ADAPTER

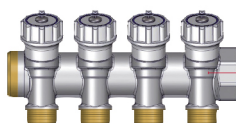

465

DISTRIBUTION MANIFOLD WITH SHUT-OFF VALVES  
1/2" male outlets, conical seat



455

DISTRIBUTION MANIFOLD  
1/2" male outlets, conical seat

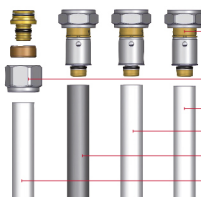

510

**multifit**

595M NUT AND ADAPTER

MULTILAYER PIPE

PEX PIPE

POLYBUTYLENE PIPE

MULTILAYER PIPE

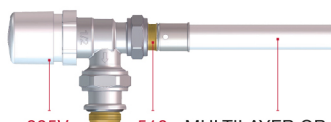

995V

510

MULTILAYER OR PEX PIPE

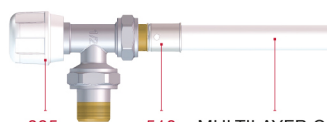

395

510

MULTILAYER OR PEX PIPE

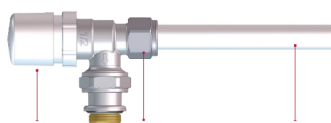

995V

595M

MULTILAYER PIPE

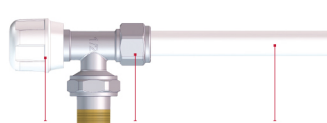

395

595M

MULTILAYER PIPE