

## Specificatii

Tensiune nominala	12V	
Capacitate nominala (10h)	250Ah	
Dimensiuni	Lungime	521 ± 2mm
	Latime	269 ± 2mm
	Inaltime carcasa	220 ± 2mm
	Inaltime totala (cu borne)	224 ± 2mm
Greutate	Approx 75,5kg	
Tip Borna	T16	
Material carcasa	ABS	
Capacitate	270,0Ah / 13,5A	20Hr, 1,80V/cell, 25°C
	255,0Ah / 25,5A	10Hr, 1,80V/cell, 25°C
	217,5Ah / 43,5A	5Hr, 1,80V/cell, 25°C
	191,4Ah / 63,8A	3Hr, 1,80V/cell, 25°C
	147Ah / 147A	1Hr, 1,75V/cell, 25°C
Curent maxim de descarcare	1500A (5s)	
Rezistenta interna	Approx 2,8mΩ	
Interval temp. de utilizare	Descarcare: -15 ÷ 50°C	
	Incarcare: -10 ÷ 50°C	
	Depozitare: -20 ÷ 50°C	
Temp. nominala de utilizare	25 ± 3°C	
Utilizare ciclica	Curent initial de incarcare: <50A. Tensiunea de incarcare: 14,50V ÷ 14,70V la 25°C. Coef. de corectie cu temp.: -30mV / °C	
Utilizare tampon (stand-by)	Curent initial de incarcare: <50A. Tensiunea de incarcare: 13,50V ÷ 13,80V la 25°C. Coef. de corectie cu temp.: -18mV / °C	
Influenta temperaturii asupra capacitatii	40°C	102%
	25°C	100%
	0°C	85%
Autodesccarcare la 25°C	3 luni	Capacitate remanenta: 91%
	6 luni	Capacitate remanenta: 82%
	12 luni	Capacitate remanenta: 65%

## Foton FSun 12 - 250 (Gel)



## Utilizari si caracteristici

Tehnologie: VRLA GEL

Surse neinteruptibile de tensiune (UPS)

Sisteme electrice de alimentare (EPS)

Sisteme de semnalizare aeriene si feroviare

Iluminat de siguranta

Centrale electrice

Echipamente cu functionare ciclica

Instalatii solare si eoliene

EN 60896-21,-22

Durata de viata proiectata: 10-12 ani

Eurobat: Long Life

## Descarcare cu curent constant (Amperi) la 25°C

Ufinal/Timp	15min	30min	60min	2h	3h	4h	5h	6h	8h	10h	20h
9.60V	428	256	158	93.2	67.1	53.6	45.8	39.8	31.5	26.0	13.8
9.90V	418	251	155	92.6	66.7	53.3	45.5	39.6	31.3	25.9	13.7
10.2V	403	243	151	91.8	66.3	52.9	45.2	39.3	31.1	25.8	13.7
10.5V	389	238	147	90.4	65.8	52.5	44.9	39.0	30.9	25.7	13.6
10.8V	368	229	142	88.1	63.8	51.0	43.5	37.8	29.9	25.5	13.5

## Descarcare cu putere constanta (Watts/bloc) la 25°C

Ufinal/Timp	15min	30min	60min	2h	3h	4h	5h	6h	8h	10h	20h
9.60V	4704	2875	1797	1079	789	630	541	470	374	310	165
9.90V	4591	2818	1770	1073	785	626	538	468	372	309	165
10.2V	4422	2732	1725	1063	779	622	534	464	369	308	164
10.5V	4271	2666	1671	1047	774	618	530	461	367	307	163
10.8V	4045	2568	1617	1021	750	599	515	447	356	304	162

### Dimensiuni exterioare (mm)

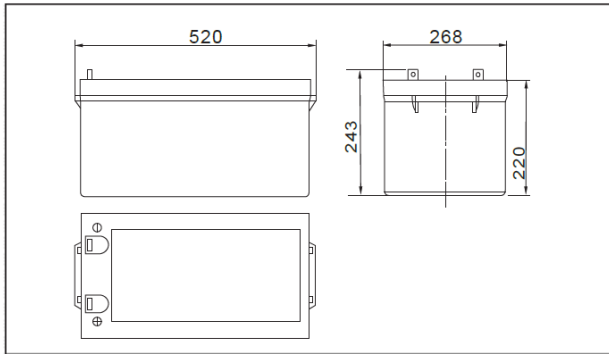

### Tip Borna (mm)

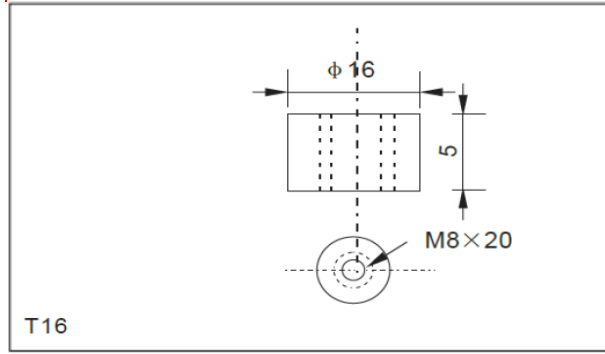

### Caracteristici de descarcare (25°C)

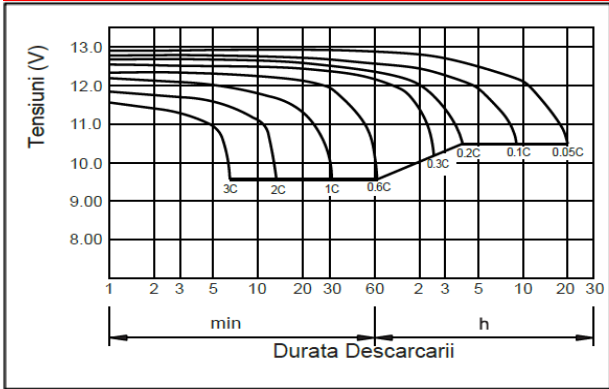

### Caracteristici de incarcare (25°C)

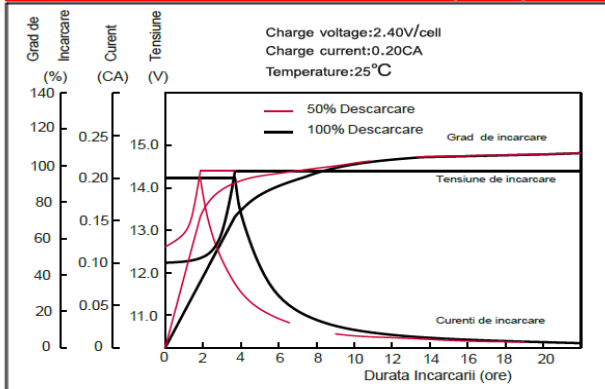

### Efectul temperaturii asupra capacitatii

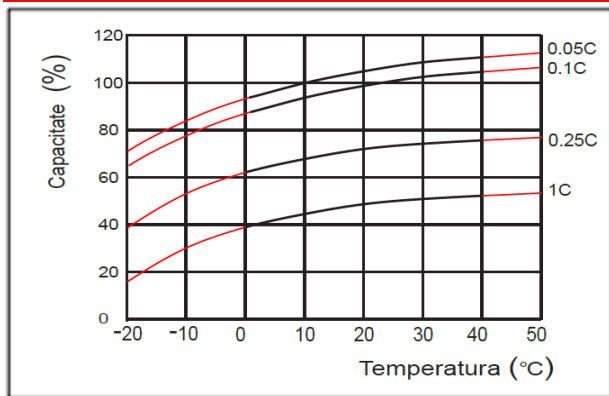

### Durata de viata in functie de temperatura

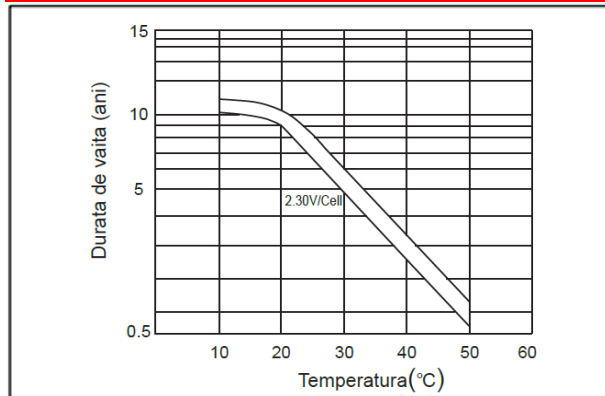

### Numar de cicluri vs D.O.D (25°C)

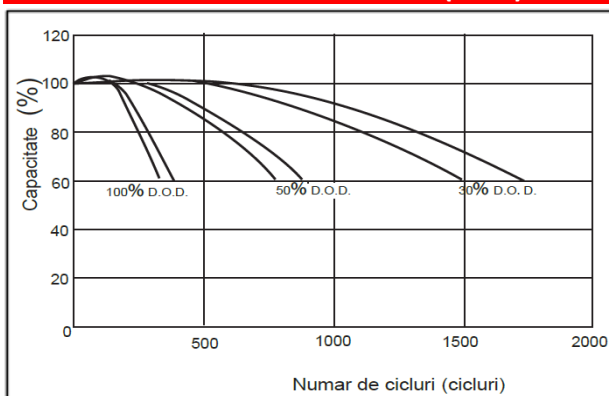

### Relatia tensiune la borne / capacitate (25°C)

